

Committed to Our Customers

Committed to Our Customers

Committed to Our Customers

Committed to Our Customers

High Quality

Cost-Effective

Timely Delivery

Advanced Design

Super Reliability

Excellent Performance

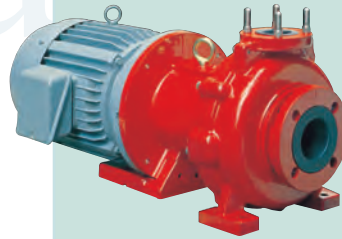

Pan World

Leader in Leak-free Technology

PX Series (Glass Fiber-reinforced PP) Compact Magnetic Drive Pump for OEM Applications

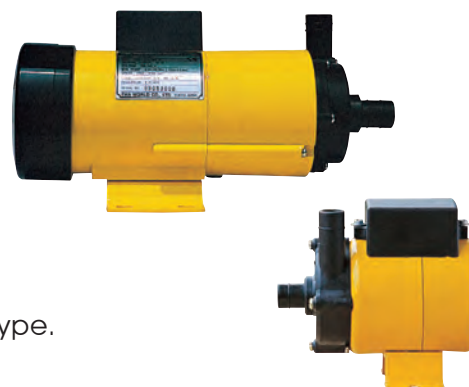

- OEM and general applications.
- 15 models with flow rates up to 80 lit/min.
- Offering ceramic bearing & ceramic spindle as standard wearing parts to achieve long life expectancy.
- Standard connections available in hose, threads or union type.

Specification table

Nominal speed : 2,500/3,000 r.p.m

Model	Connection method			Performance M-L/min, 50-60Hz		Motor
	Hose(mm)	Thread(“)	Union(A)	Max total head-max discharge	Specified head-specified discharge	Output x Input(W)
	In x Outlet	In x Outlet	In x Outlet			
1PX	14x14	G1/2x1/2	----	0.9-7.0 / 1.2-8.0	0.7-2.6 / 0.8-4.5	2.5 - 17 / 18
1PX-Z	14x14	G1/2x1/2	----	2.0-5.5 / 2.8-7.0	1.5-3.0 / 1.5-4.3	5 - 20 / 21
3PX	14x14	G1/2x1/2	----	1.4-10.0 / 2.0-11.5	1.0-4.8 / 1.0-7.5	5 - 19 / 20
5PX	14x14	G1/2x1/2	----	0.9-7.0 / 1.2-8.0	0.7-2.6 / 0.8-4.5	2.5 - 17 / 18
5PX-Z	14x14	G1/2x1/2	----	2.0-5.5 / 2.8-7.0	1.5-3.0 / 1.5-4.3	5 - 20 / 21
10PX	14x14	G1/2x1/2	----	1.4-10.0 / 2.0-11.5	1.0-4.8 / 1.0-7.5	5 - 19 / 20
30PX	14x14	G3/4x3/4	16x16	2.1-15.0 / 3.1-18.0	1.5-7.0 / 1.5-13.0	10 - 29 / 30
40PX	18x18	G3/4x3/4	16x16	2.6-25.0 / 4.1-30.0	2.0-14.0 / 2.0-22.0	20 - 40 / 45
50PX-Z	18x18	G3/4x3/4	16x16	4.8-9.5 / 6.7-11.0	4.0-3.5 / 4.0-8.0	20 - 40 / 55
50PX	20x20	G3/4x3/4	16x16	3.5-30.0 / 5.0-37.0	2.5-15.0 / 2.5-24.0	45 - 65 / 90
50PX-X	26x26	G1x1	20x20	2.8-55.0 / 4.0-70.0	2.0-30.0 / 2.0-40.0	45 - 65 / 80
100PX-Z	18x18	G3/4x3/4	16x16	8.0-14.0 / 11.0-18.0	5.0-9.0 / 6.0-13.0	45 - 80 / 95
100PX	20x20	G3/4x3/4	16x16	4.2-43.0 / 6.3-50.0	4.0-20.0 / 4.0-31.0	65 - 90 / 120
100PX-X	26x26	G1x1	20x20	3.0-70.0 / 4.0-80.0	2.0-45.0 / 2.0-60.0	65 - 120 / 165
100PX-ZZ	20x20	G3/4x3/4	16x16	11.5-22.0 / 13.5-24.0	9.5-10.0 / 6.0-20.0	65 - 140 / 200

Note: NPT thread is available.

Pump performance curve

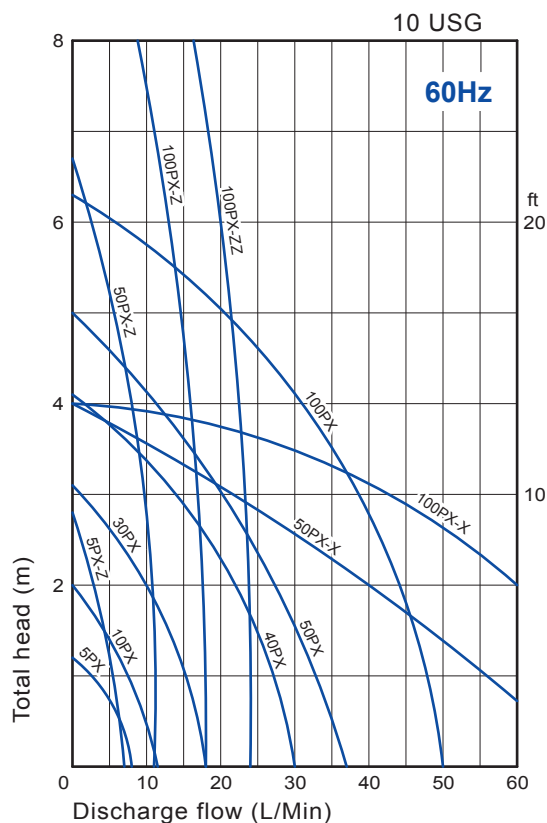
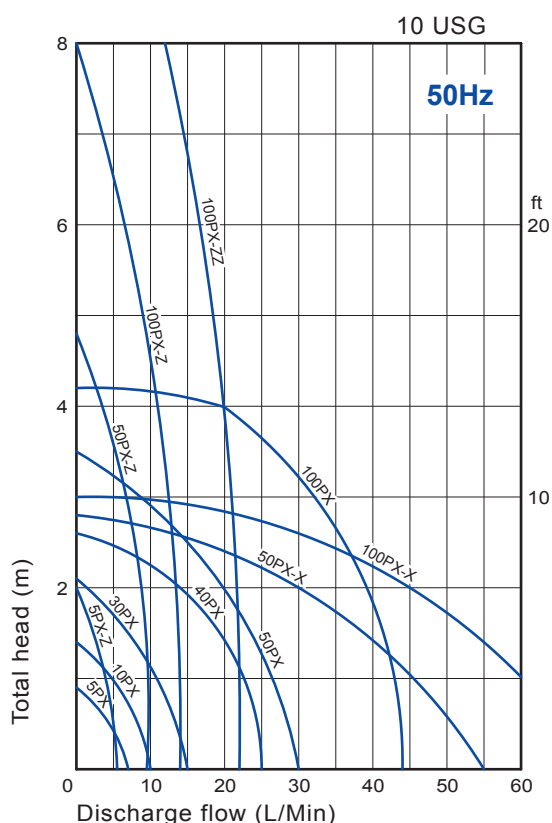

PX-N Series (Natural)

Compact Magnetic Drive Pump for Semiconductor Application

- With PvdF natural wetted-end and ceramic or Sic bearing & spindle, these pumps are well made for semiconductor application.
- 15 models with flow rates up to 80 lit/min.
- Standard connections available in hose, threads or union type.



PX-F Series (Carbon Fiber-reinforced ETFE)

Compact Magnetic Drive Pump for hazardous chemical transfer

- ETFE wetted-end material for highly hazardous chemical transfer.
- 9 models with flow rates up to 80 lit/min.
- Standard connections available in hose, threads or union type.

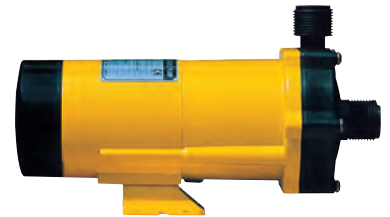

Pump performance curve

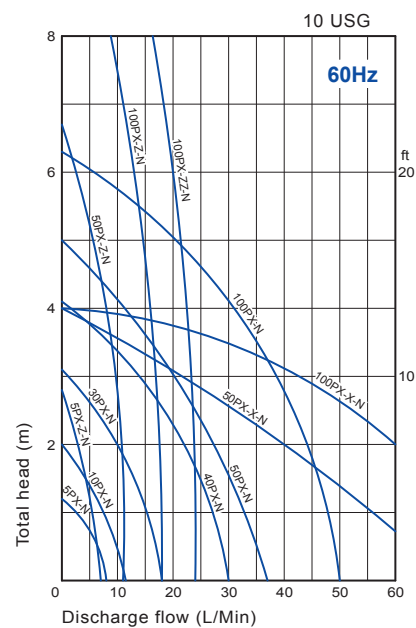
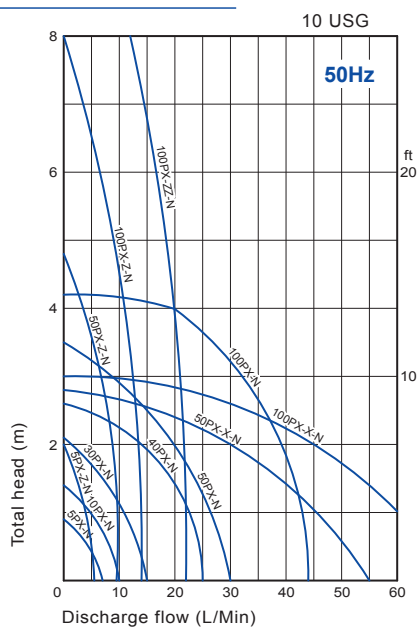

Specification table

Nominal speed : 2,500/3,000 r.p.m

Model	Connection method			Performance M-L/min, 50~60Hz		Motor
	Hose(mm) In × Outlet	Thread(″) In × Outlet	Union(A) In × Outlet	Max total head- max discharge	Specified head- specified discharge	Output × Input(W)
1PX-N	14×14	G1/2×1/2	----	0.9-7.0 / 1.2-8.0	0.7-2.6 / 0.8-4.5	2.5 - 17 / 18
1PX-Z-N	14×14	G1/2×1/2	----	2.0-5.5 / 2.8-7.0	1.5-3.0 / 1.5-4.3	5 - 20 / 21
3PX-N	14×14	G1/2×1/2	----	1.4-10.0 / 2.0-11.5	1.0-4.8 / 1.0-7.5	5 - 19 / 20
5PX-N	14×14	G1/2×1/2	----	0.9-7.0 / 1.2-8.0	0.7-2.6 / 0.8-4.5	2.5 - 17 / 18
5PX-Z-N	14×14	G1/2×1/2	----	2.0-5.5 / 2.8-7.0	1.5-3.0 / 1.5-4.3	5 - 20 / 21
10PX-N	14×14	G1/2×1/2	----	1.4-10.0 / 2.0-11.5	1.0-4.8 / 1.0-7.5	5 - 19 / 20
30PX-N/30PX-F	14×14	G3/4×3/4	16×16	2.1-15.0 / 3.1-18.0	1.5-7.0 / 1.5-13.0	10 - 29 / 30
40PX-N/40PX-F	18×18	G3/4×3/4	16×16	2.6-25.0 / 4.1-30.0	2.0-14.0 / 2.0-22.0	20 - 40 / 45
50PX-Z-N/50PX-Z-F	18×18	G3/4×3/4	16×16	4.8-9.5 / 6.7-11.0	4.0-3.5 / 4.0-8.0	20 - 40 / 55
50PX-N/50PX-F	20×20	G3/4×3/4	16×16	3.5-30.0 / 5.0-37.0	2.5-15.0 / 2.5-24.0	45 - 65 / 90
50PX-X-N/50PX-X-F	26×26	G1×1	20×20	2.8-55.0 / 4.0-70.0	2.0-30.0 / 2.0-40.0	45 - 65 / 80
100PX-Z-N/100PX-Z-F	18×18	G3/4×3/4	16×16	8.0-14.0 / 11.0-18.0	5.0-9.0 / 6.0-13.0	45 - 80 / 95
100PX-N/100PX-F	20×20	G3/4×3/4	16×16	4.2-43.0 / 6.3-50.0	4.0-20.0 / 4.0-31.0	65 - 90 / 120
100PX-X-N/100PX-X-F	26×26	G1×1	20×20	3.0-70.0 / 4.0-80.0	2.0-45.0 / 2.0-60.0	65 - 120 / 165
100PX-ZZ-N/100PX-ZZ-F	20×20	G3/4×3/4	16×16	11.5-22.0 / 13.5-24.0	9.5-10.0 / 6.0-20.0	65 - 140 / 200

Note : NPT thread is available.

PX-D Series (Glass-filled Polypropylene)

PX-D-N Series (Pvdf Natural)

PX-D-F Series (Carbon Fiber-filled ETFE)

Magnetic Drive Pump with Computer-controlled DC brush-less motor, fixed-speed & variable-speed



- Magnetic Drive Pump equipped with DC brush-less motor, printed circuit board & variable speed controller.
- Wetted-end materials in PP,Pvdf or ETFE to meet different requirements.
- Can accept external 4-20mA for maintaining constant flow and pressure and also pH adjustment.
- Motor efficiency doubles that of the AC type.
- Space saving.

Specification table

Model	Connection method			Maximum Performance					
	Wetted end	Hose(mm)	Thread(″)	Union(A)	Head(M)-Discharge flow (L/min)				
Polypropylene/Pvdf/ETFE		In x Outlet	In x Outlet	In x Outlet	2,000r.p.m	2,500r.p.m	3,000r.p.m	3,500r.p.m	4,000r.p.m
5PX-D, 5PX-D-N	14x14	G1/2x1/2	----	----	0.9 - 8.5	1.2 - 11.5	1.9 - 13.5	2.8 - 15.0	----
10PX-D, 10PX-D-N	14x14	G1/2x1/2	----	----	1.2 - 10.0	1.6 - 12.0	2.5 - 13.0	----	----
5PX-Z-D, 5PX-Z-D-N	14x14	G1/2x1/2	----	----	1.5 - 8.0	2.2 - 10.0	2.8 - 12.0	----	----
30PX-D/30PX-D-N 30PX-D-F	14x14	G3/4x3/4	16x16	1.2-14.5	1.6 - 16.0	2.6 - 17.0	3.6 - 22.0	----	----
40PX-D/40PX-D-N 40PX-D-F	18x18	G3/4x3/4	16x16	1.7-18.0	2.3 - 22.0	3.1 - 26.0	3.9 - 30.0	----	----
50PX-Z-D/50PX-Z-D-N 50PX-Z-D-F	18x18	G3/4x3/4	16x16	2.6-12.0	4.2 - 13.0	5.0 - 13.5	----	----	----

Note : NPT thread is available.

Pump performance curve

5PX-D/5PX-D-N

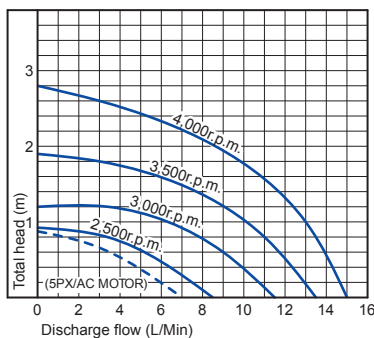

5PX-Z-D/5PX-Z-D-N

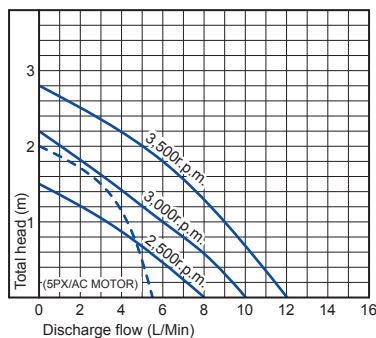

10PX-D/10PX-D-N

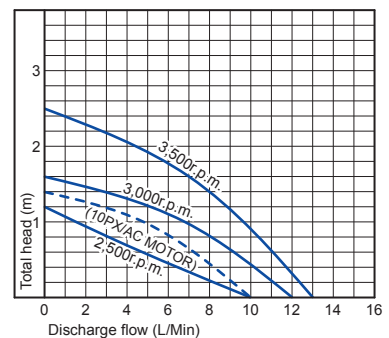

30PX-D/30PX-D-N/30PX-D-F

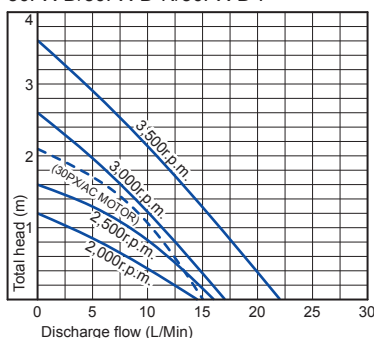

40PX-D/40PX-D-N/40PX-D-F

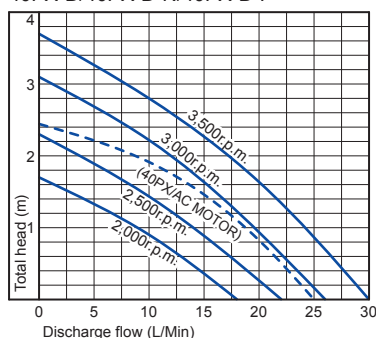

50PX-Z-D/50PX-Z-D-N/50PX-Z-D-F

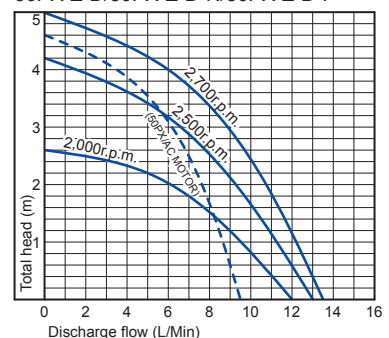

3 Note: Broken Line shows pump performance of PX Series with AC motor.

PI-Z-D Series

Magnetic Drive Pump with computer-controlled DC brush-less motor, fixed-speed & variable-speed

- Magnetic Drive Pump equipped with DC brush-less motor, printed circuit board & variable speed controller.
- Can accept external 4-20mA for maintaining constant flow and pressure and also pH adjustment.
- Motor efficiency doubles that of the AC type.
- Space saving.



Specification table

Model	Connection Discharge × Suction mm(inch)	Max flow L/min (GPM)	Max head m (ft)	Motor		
				Power (V)	Output × Input (w)	Speed (rpm)
NH-5PI-Z-D	8×14 (5/16"×9/16")	6 (1.6)	4.5 (14.8)	DC24V,DC12V	8 × 13	3700
NH-10PI-Z-D	8×14 (5/16"×9/16")	8 (2.2)	9 (29)	DC24V	18 × 30	5500
NH-15PI-Z-D	8×18 (5/16"×11/16")	8 (2.2)	9 (29)	DC24V	20 × 45	3200
NH-20PI-Z-D	18×18 (11/16"×11/16")	16 (4.2)	8.2 (27)	DC24V	30 × 55	3000
NH-30PI-Z-D	18×18 (11/16"×11/16")	20 (5.4)	11(36)	DC24V	45 × 65	3300

Pump performance curve

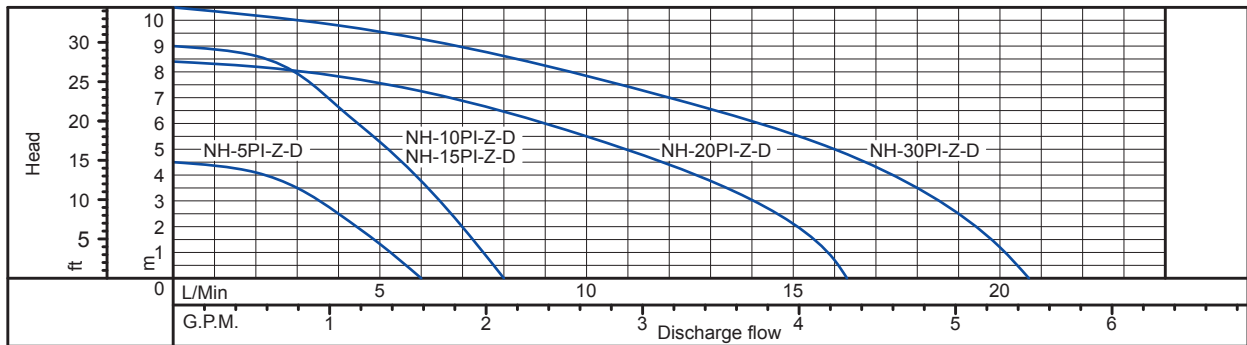

Installation dimension

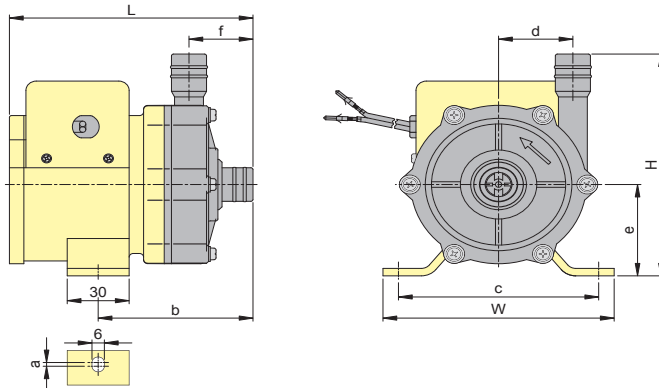

NH-PI-Z-D Dimensions in mm(inch)

Model	W	H	L	a	b	c	d	e	f
NH-5PI-Z-D	74 (2.91")	90 (3.54")	100 (3.94")	0 (0")	67.5 (2.66")	60 (2.36")	21 (0.83")	4.5 (1.77")	26.5 (1.04")
NH-10PI-Z-D	74 (2.91")	90 (3.54")	100 (3.94")	0 (0")	67.5 (2.66")	60 (2.36")	21 (0.83")	4.5 (1.77")	26.5 (1.04")
NH-15PI-Z-D	112 (4.41")	119 (4.69")	118 (4.65")	2 (0.08")	75 (2.95")	97 (3.82")	36 (1.42")	49 (1.93")	31 (1.22")
NH-20PI-Z-D	112 (4.41")	119 (4.69")	118 (4.65")	2 (0.08")	75 (2.95")	97 (3.82")	36 (1.42")	49 (1.93")	31 (1.22")
NH-30PI-Z-D	112 (4.41")	119 (4.69")	123 (4.84")	2 (0.08")	75 (2.95")	97 (3.82")	36 (1.42")	49 (1.93")	31 (1.22")

PS Series (PPG) General Purpose Magnetic Drive Pumps



- OEM & general applications.
- 11 models with flow rates up to 120 lit/min.
- Available in hose, threaded and flange connections.
- Cost saving PP wetted-end material.

Specification table

Nominal speed : 2,700/3,200 r.p.m

Model	Connection method				Performance M-L/min, 50-60Hz		Motor
	Hose(mm) In x Outlet	Thread(") In x Outlet	Union(A) In x Outlet	Flange(A) In x Outlet	Max total head- max discharge	Specified head- specified discharge	Output x Input(W)
125PS (N)	26 x 26	NPT1 x 1, G1/1	20 x 20	-----	3.3-75 / 4.7-85	2-47 / 2-65	65-90/130
150PS	26 x 26	NPT1 x 1, G1/1	20 x 20	25 x 25	5.6-60 / 8.2-70	4-30 / 4-45	90-130/170
150PS-3	26 x 26	NPT1 x 1, G1/1	20 x 20	25 x 25	5.6-60 / 8.2-70	4-30 / 4-45	90-130/170
200PS-Z	26 x 26	NPT1 x 1, G1/1	20 x 20	25 x 25	12.5-35 / 16-37	9-20 / 8-30	150-290
200PS	26 x 26	NPT1 x 1, G1/1	20 x 20	25 x 25	10-90 / 12-110	6.5-50 / 7.5-70	150-290
200PS-3	26 x 26	NPT1 x 1, G1/1	20 x 20	25 x 25	10-90 / 12-110	6.5-50 / 7.5-70	150-290
250PS	26 x 26	NPT1 x 1, G1/1	20 x 20	25 x 25	12.5-120 / 14-120	9-65 / 9-80	250-390
250PS-3	26 x 26	NPT1 x 1, G1/1	20 x 20	25 x 25	12.5-120 / 14-120	9-65 / 9-80	250-390
250PS-3E	26 x 26	NPT1 x 1, G1/1	20 x 20	25 x 25	12.5-120 / 14-120	9-65 / 9-80	JEM-0.2kW
300PS	26 x 20	NPT1 x 3/4, G1 x 3/4	20 x 16	-----	20-50 / 25-50	16-50 / 21-50	330-460
300PS-3	26 x 20	NPT1 x 3/4, G1 x 3/4	20 x 16	-----	20-50 / 25-50	16-50 / 21-50	330-460

Pump performance curve

Nominal speed : 2,700 r.p.m

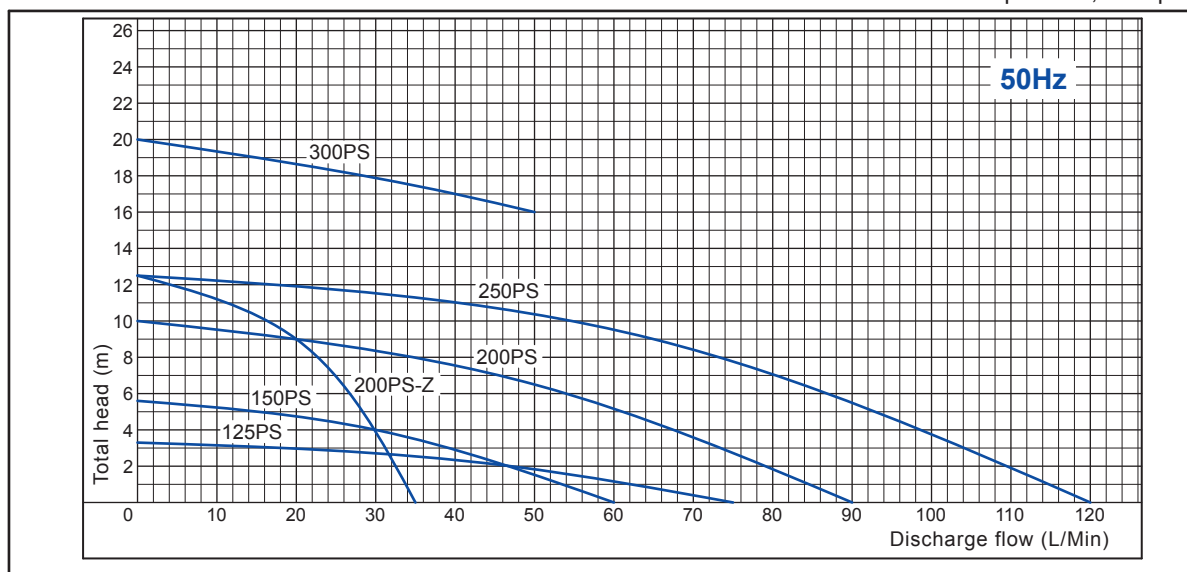

Nominal speed : 3,200 r.p.m

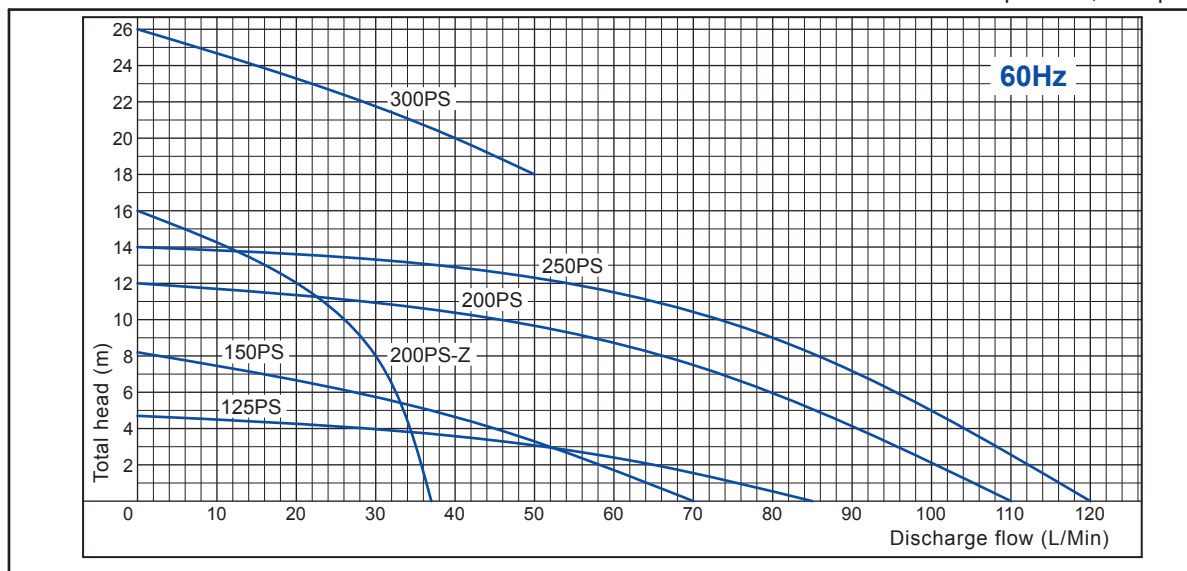

PS-F Series (ETFE)

Magnetic Drive Pumps For Hazardous Chemical Transfer

- ETFE wetted-end material for hazardous chemical transfer.
- 11 models with flow rates up to 120 lit/min.
- Available in hose, threaded or flange connections.

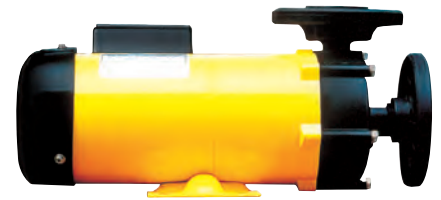

Specification table

Nominal speed : 2,700/3,200 r.p.m

Model	Connection method				Performance, M-L/min, 50~60Hz		Motor
	Hose(mm) In x Outlet	Thread(") In x Outlet	Union(A) In x Outlet	Flange(A) In x Outlet	Max total head- max discharge	Specified head- specified discharge	Output x Input(W)
125PS-F	26×26	NPT1×1,G1×1	20×20	-----	3.3-75 / 4.7-85	2-47 / 2-65	65-90/130
150PS-F	26×26	NPT1×1,G1×1	20×20	25×25	5.6-60 / 8.2-70	4-30 / 4-45	90-130/170
150PS-F-3	26×26	NPT1×1,G1×1	20×20	25×25	5.6-60 / 8.2-70	4-30 / 4-45	90-130/170
200PS-Z-F	26×26	NPT1×1,G1×1	20×20	25×25	12.5-35 / 16-37	9-20 / 8-30	150-290
200PS-F	26×26	NPT1×1,G1×1	20×20	25×25	7.5-70 / 7.5-70	5.5-50 / 5.5-50	150-290
200PS-F-3	26×26	NPT1×1,G1×1	20×20	25×25	7.5-70 / 7.5-70	5.5-50 / 5.5-50	150-290
250PS-F	26×26	NPT1×1,G1×1	20×20	25×25	11.5-80 / 11.5-80	8.5-50 / 8.5-50	250-390
250PS-F-3	26×26	NPT1×1,G1×1	20×20	25×25	11.5-80 / 11.5-80	8.5-50 / 8.5-50	250-390
250PS-F-3E	26×26	NPT1×1,G1×1	20×20	25×25	12.5-120 / 14-120	9-65 / 9-80	JEM-0.2kW
300PS-F	26×20	NPT1×3/4,G1×3/4	20×16	-----	20-50 / 25-50	16-50 / 21-50	330-460
300PS-F-3	26×20	NPT1×3/4,G1×3/4	20×16	-----	20-50 / 25-50	16-50 / 21-50	330-460

Pump performance curve

Nominal speed : 2,700 r.p.m

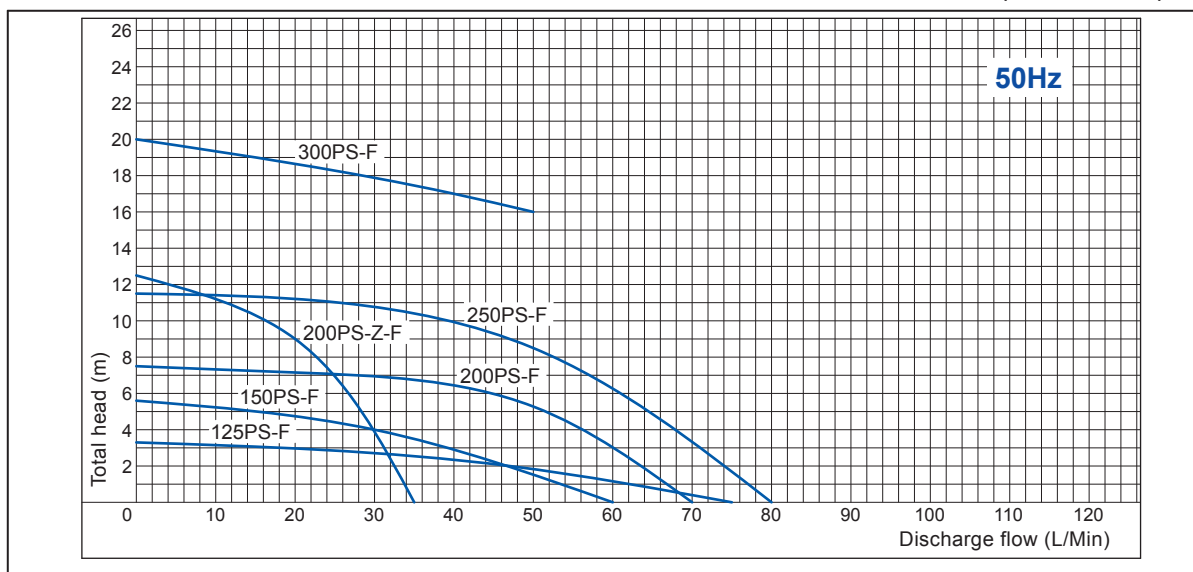

Nominal speed : 3,200 r.p.m

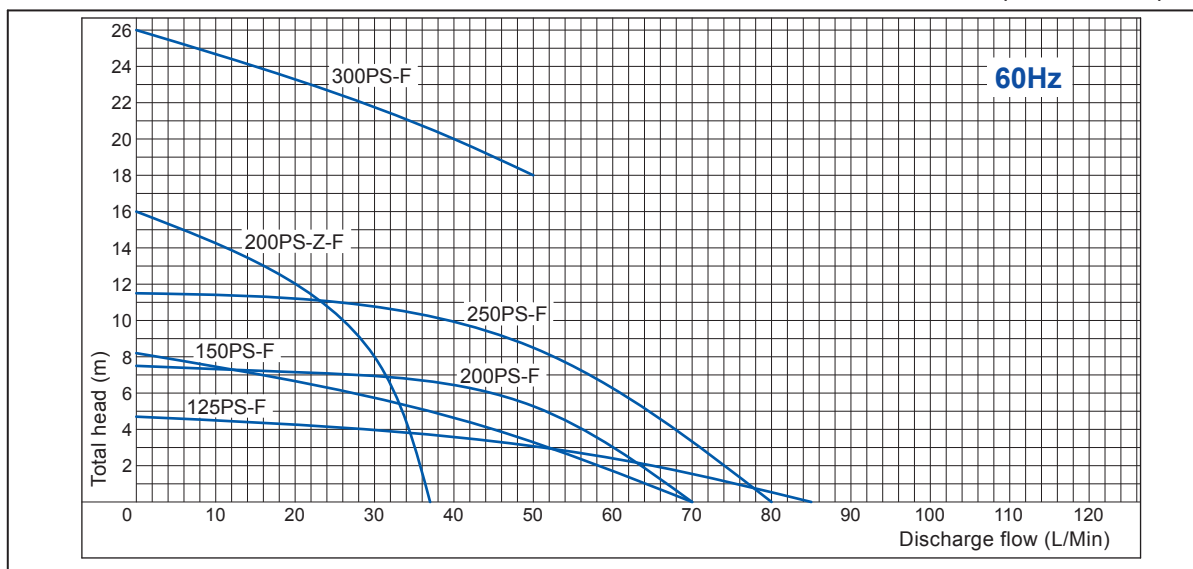

PW Series (PPG)

General Purpose Magnetic Drive Pumps

- PPG wetted-end material.
- 16 models with flow rates up to 1400 lit/min and discharge head of 44m.
- Able to handle many types of chemical and temperature up to 70°C.
- Adaptable to IEC Standard motor, 0.37 to 11 kW.
- Available in flange connections.



Type indication

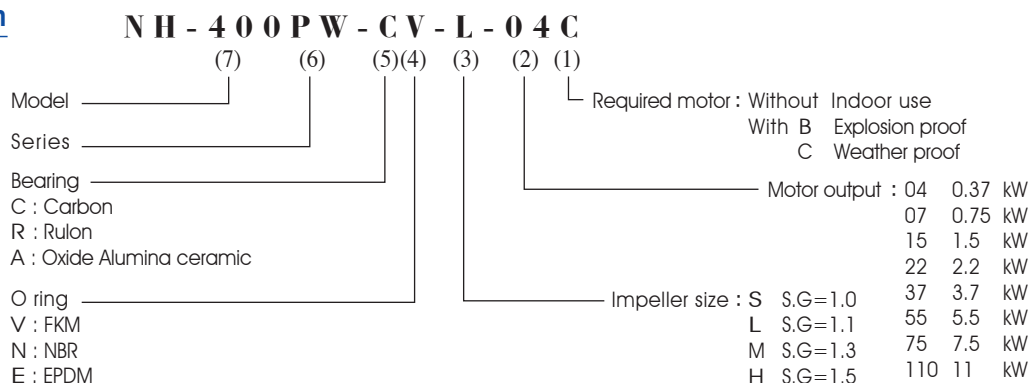

Specification table

Type	Flange size		Pump performance at specified point (M at L/min)			Applicable Motor output (kW)	Net weight w/t motor (Kg)
	Outlet(mm)	Inlet(mm)	Specific Gravity	50Hz	60Hz		
NH-350PW	25	25	1.0	11.0 - 80	13.0 - 80	0.37	16
			1.3	12.0 - 60	14.0 - 40		
			1.5	11.0 - 40	11.0 - 50		
NH-351PW	25	25	1.0	13.7 - 100	17.3 - 100	0.75	25
			1.3	14.5 - 80	17.0 - 80		
			1.5	12.4 - 80	14.5 - 70		
NH-352PW	32	32	1.0	23.0 - 180	29.0 - 140	1.5	37
			1.3	22.0 - 100	26.0 - 100		
			1.5	21.0 - 100	25.0 - 100		
NH-353PW	32	32	1.0	23.0 - 180	32.0 - 150	2.2	46
			1.3	24.0 - 150	31.0 - 120		
			1.5	22.0 - 150	29.0 - 120		
NH-400PW	40	40	1.1	8.3 - 165	6.7 - 160	0.37	21
			1.3	7.0 - 155	7.0 - 155		
			1.5	6.1 - 130	5.9 - 130		
NH-401PW	40	40	1.1	12.0 - 240	11.5 - 250	0.75	30
			1.3	9.8 - 185	9.2 - 200		
			1.5	9.1 - 165	7.5 - 200		
NH-402PW	40	50	1.1	14.0 - 320	14.0 - 300	1.5	45
			1.3	14.0 - 280	13.9 - 265		
			1.5	12.0 - 280	14.5 - 220		
NH-403PW	40	50	1.1	20.0 - 310	19.0 - 280	2.2	53
			1.3	16.0 - 340	17.0 - 280		
			1.5	15.5 - 340	14.7 - 340		
NH-405PW	40	50	1.1	23.0 - 390	24.0 - 420	3.7	64
			1.3	21.1 - 400	24.0 - 390		
			1.5	19.0 - 390	20.0 - 390		
NH-505PW(L)	50	65	1.0	22.0 - 500	22.0 - 500	3.7	72
			1.1	20.0 - 500	20.0 - 500		
			1.3	19.0 - 500	19.0 - 500		
			1.5	16.0 - 500	16.0 - 500		
NH-505PW(H)	50	65	1.0	25.0 - 350	28.0 - 350	3.7	72
			1.1	25.0 - 350	26.0 - 350		
			1.3	22.0 - 350	24.0 - 350		
			1.5	20.0 - 350	19.7 - 350		
NH-507PW	50	65	1.0	24.0 - 600	27.0 - 600	5.5	99
			1.1	22.0 - 600	24.0 - 600		
			1.3	19.0 - 600	21.0 - 600		
			1.5	19.0 - 600	19.0 - 600		
NH-655PW	65	80	1.1	15.0 - 700	15.5 - 600	3.7	110
			1.3	12.0 - 650	-		
			1.5	10.2 - 570	-		
NH-657PW	65	80	1.1	17.5 - 800	18.0 - 750	5.5	120
			1.3	17.6 - 630	16.5 - 630		
			1.5	15.3 - 620	13.3 - 760		
NH-6510PW	65	80	1.1	23.4 - 780	23.4 - 800	7.5	130
			1.3	22.7 - 640	19.6 - 770		
			1.5	17.5 - 800	18.1 - 670		
NH-6515PW	65	80	1.1	25.5 - 1040	29.5 - 1030	11	140
			1.3	25.5 - 1040	31.5 - 650		
			1.5	25.2 - 880	24.6 - 850		

PW Series Parts List

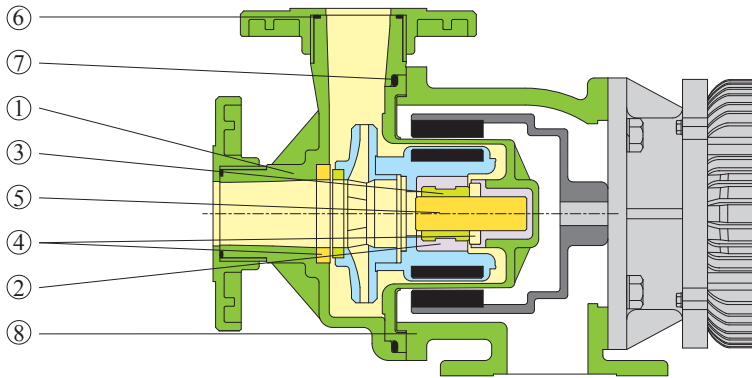

Legend	PW Series				
	CV	RV	AV	CN	AN
□□□□□□□□	PPG				
□□□□□□□□	ETFE				
□□□□□□□□	H.D. Carbon	Rulon	Ceramic	H.D. Carbon	Ceramic
□□□□□□□□	Ceramic				
□□□□□□□□	Ceramic				
□□□□□□□□	FKM		NBR		
□□□□□□□□	FKM		NBR		
□□□□□□□□	Grey cast iron				

PW series performance curve

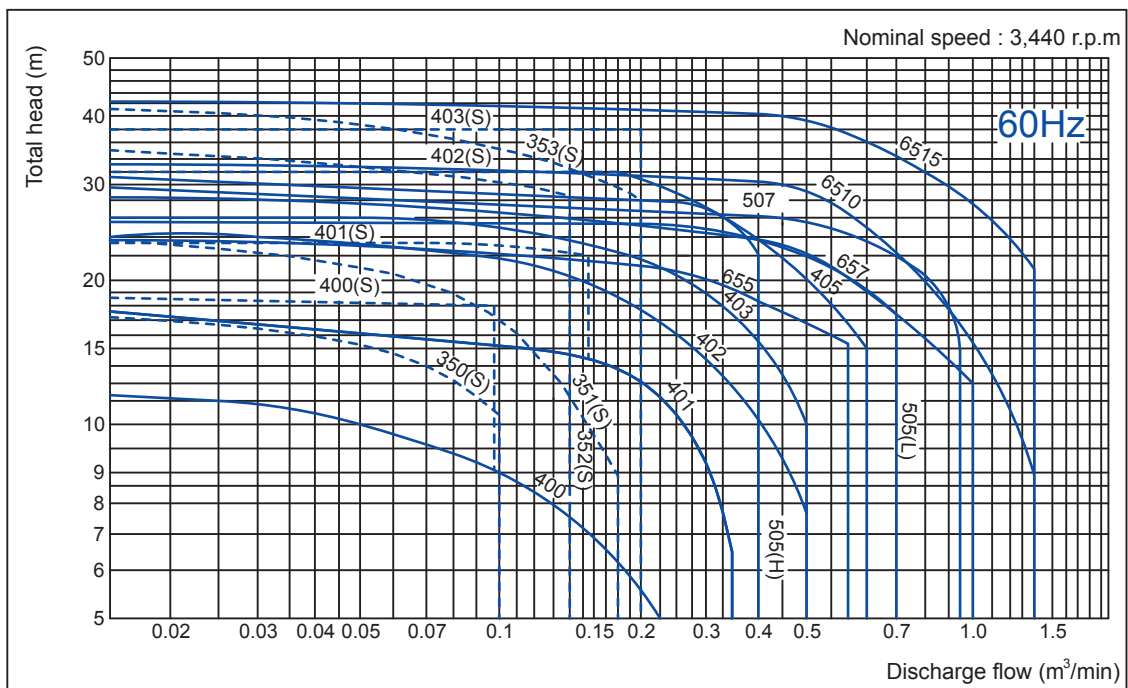
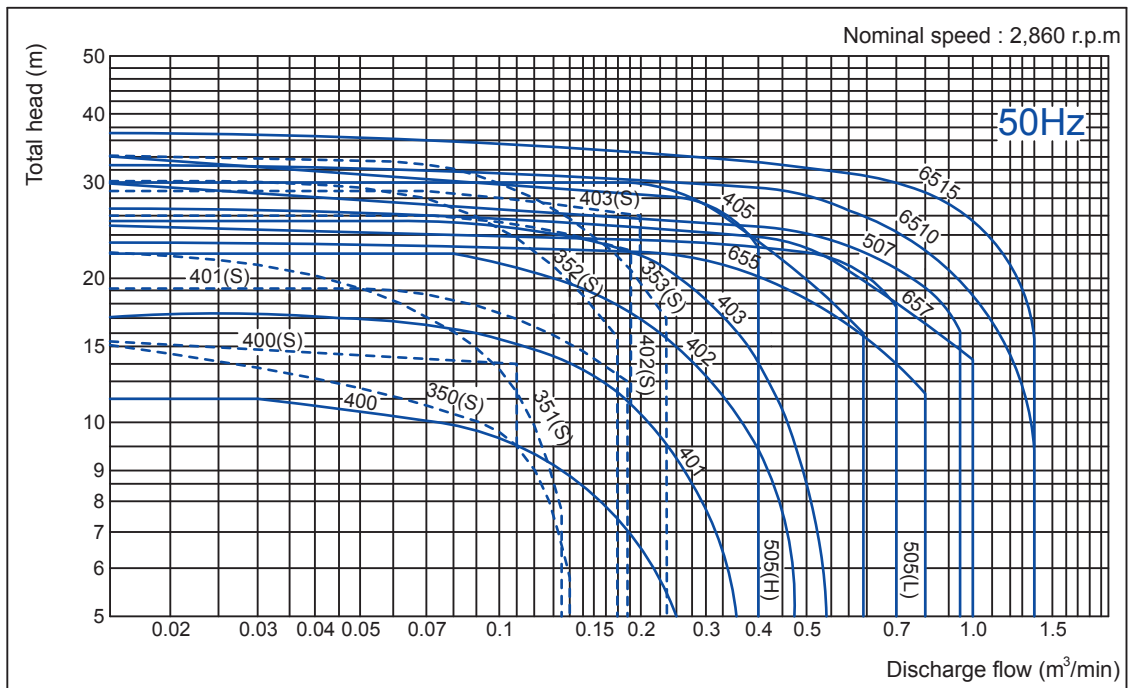

PW-F Series (ETFE)

Magnetic Drive Pumps For Hazardous Chemical Transfer

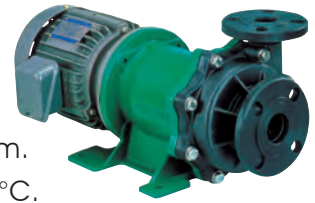

- ETFE (carbon-fiber reinforced) wetted-end material.
- 16 models with flow rates up to 1400 lit/min and discharge head of 42m.
- Able to handle almost all types of chemical and temperature up to 90°C.
- Adaptable to IEC Standard motor, 0.37 to 11 kW.
- Available in flange connections.

Type indication

	NH - 400PW - F - FV - L - 04C							
		(7)	(6)	(5)(4)	(3)	(2)	(1)	
Model	_____		_____	_____	_____	_____	_____	Required motor : Without Indoor use With B Explosion proof C Weather proof
Series	_____		_____	_____	_____	_____	_____	
F : High density carbon bearing	_____		_____	_____	_____	_____	_____	Motor output : 04 0.37 kW 07 0.75 kW 15 1.5 kW 22 2.2 kW 37 3.7 kW 55 5.5 kW 75 7.5 kW 110 11 kW
-Ceramic spindle	_____		_____	_____	_____	_____	_____	
R : Rulon bearing-Ceramic spindle	_____		_____	_____	_____	_____	_____	
A : Ceramic bearing-Ceramic spindle	_____		_____	_____	_____	_____	_____	
Si : Sic bearing-Sic spindle	_____		_____	_____	_____	_____	_____	Impeller size : L S.G=1.2 M S.G=1.5 H S.G=1.9
O ring	_____		_____	_____	_____	_____	_____	
V : FKM	_____		_____	_____	_____	_____	_____	
N : NBR	_____		_____	_____	_____	_____	_____	
E : EPDM	_____		_____	_____	_____	_____	_____	

Specification table

Type	Flange size		Pump performance at specified point (M at L/min)			Applicable Motor output (kW)	Net weight w/t motor (Kg)
	Outlet(mm)	Inlet(mm)	Specific Gravity	50Hz	60Hz		
NH-350PW-F	25	25	1.2	10.0 - 80	11.0 - 80	0.37	16
			1.5	11.0 - 40	11.0 - 50		
			1.9	6.0 - 50	7.0 - 60		
NH-351PW-F	25	25	1.2	15.0 - 100	17.0 - 80	0.75	25
			1.5	12.4 - 80	14.5 - 70		
			1.9	12.0 - 80	14.5 - 20		
NH-352PW-F	32	32	1.2	23.0 - 100	27.0 - 100	1.5	38
			1.5	21.0 - 100	25.0 - 100		
			1.9	18.0 - 100	21.0 - 100		
NH-353PW-F	32	32	1.2	24.0 - 150	32.0 - 120	2.2	46
			1.5	22.0 - 150	29.0 - 120		
			1.9	19.0 - 150	25.0 - 120		
NH-400PW-F	40	40	1.2	7.4 - 135	8.0 - 110	0.37	21
			1.5	6.5 - 135	5.2 - 135		
			1.9	4.7 - 120	3.9 - 120		
NH-401PW-F	40	40	1.2	10.0 - 180	9.5 - 180	0.75	30
			1.5	8.5 - 160	8.8 - 160		
			1.9	6.0 - 175	5.2 - 175		
NH-402PW-F	40	50	1.2	16.0 - 260	15.5 - 260	1.5	45
			1.5	13.0 - 240	13.5 - 240		
			1.9	10.0 - 280	7.9 - 280		
NH-403PW-F	40	50	1.2	17.0 - 330	15.0 - 330	2.2	53
			1.5	15.0 - 310	16.3 - 310		
			1.9	14.0 - 280	13.0 - 280		
NH-405PW-F	40	50	1.2	24.5 - 390	20.5 - 390	3.7	64
			1.5	20.5 - 310	20.3 - 350		
			1.9	15.2 - 220	19.3 - 290		
NH-505PW-F(L)	50	65	1.2	21.0 - 500	20.0 - 500	3.7	72
			1.5	16.0 - 500	16.0 - 500		
			1.9	13.0 - 500	11.0 - 500		
NH-505PW-F(H)	50	65	1.2	24.3 - 350	25.0 - 350	3.7	72
			1.5	20.0 - 350	19.7 - 350		
			1.9	20.0 - 350	17.0 - 350		
NH-507PW-F	50	65	1.2	21.5 - 600	22.5 - 600	5.5	99
			1.5	19.0 - 600	19.5 - 600		
			1.9	16.0 - 600	15.0 - 600		
NH-655PW-F	65	80	1.2	12.2 - 600	19.8 - 400	3.7	110
			1.5	11.0 - 540	- - -		
			1.9	- - -	- - -		
NH-657PW-F	65	80	1.2	17.0 - 700	18.0 - 620	5.5	120
			1.5	15.3 - 625	13.5 - 750		
			1.9	11.3 - 660	- - -		
NH-6510PW-F	65	80	1.2	22.2 - 760	20.7 - 830	7.5	130
			1.5	18.9 - 720	18.0 - 680		
			1.9	15.5 - 660	15.0 - 720		
NH-6515PW-F	65	80	1.2	26.8 - 1080	24.0 - 1110	11	140
			1.5	26.0 - 815	26.0 - 800		
			1.9	24.1 - 600	20.5 - 835		

PW-F Series

Parts List

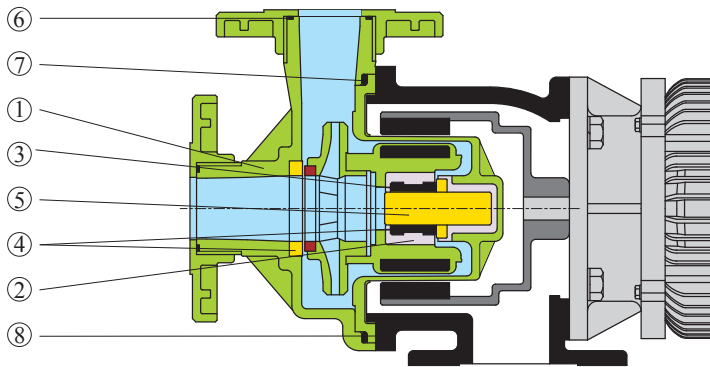

	ETFE				
	ETFE				
	H.D. Carbon	Rulon	Ceramic	H.D. Carbon	Sic
	Ceramic				Sic
	Ceramic				Sic
	FKM		NBR	FKM	
	FKM		NBR	FKM	
	Grey cast iron				

PW-F series performance curve

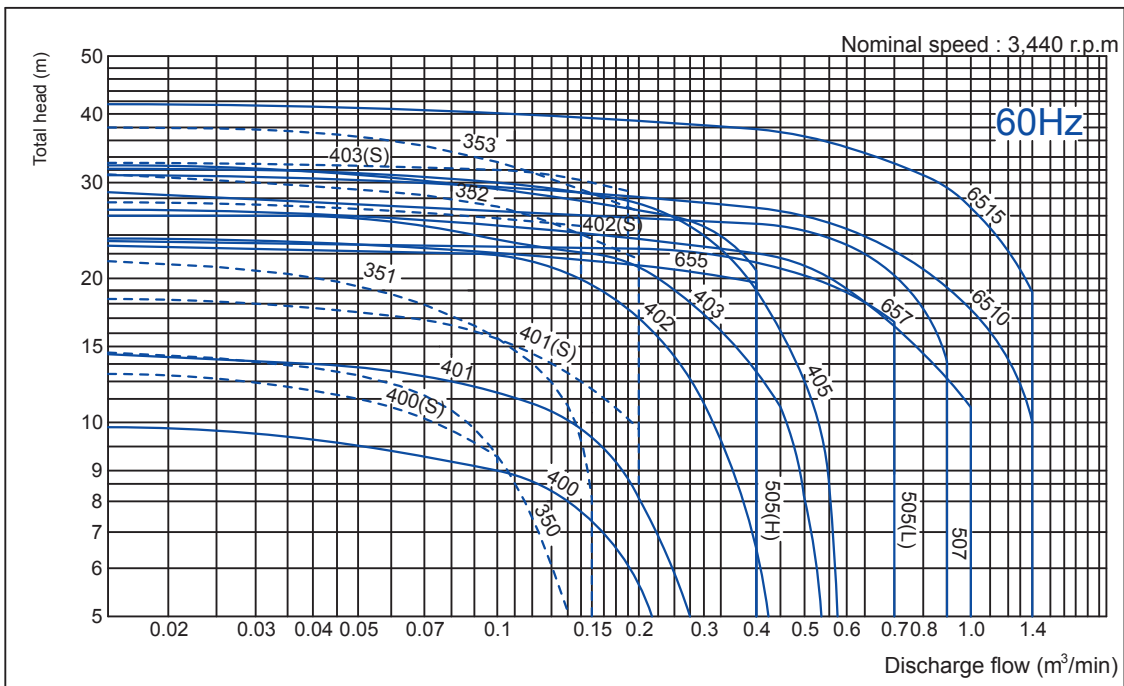
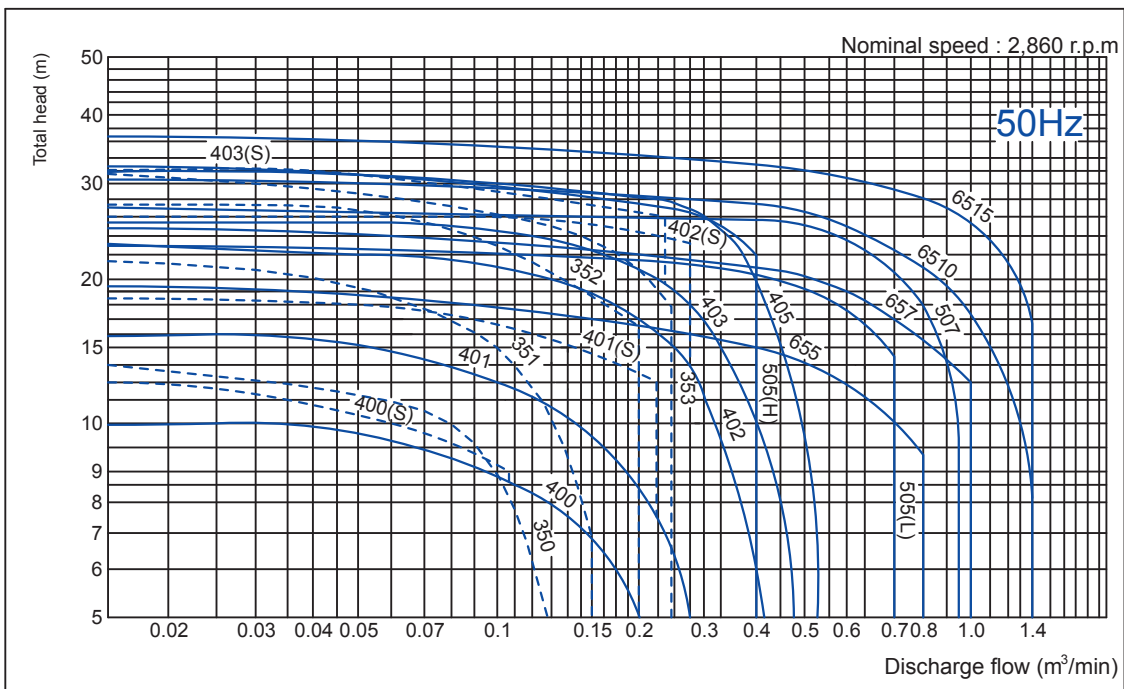

PW/PW-F Series Installation dimension

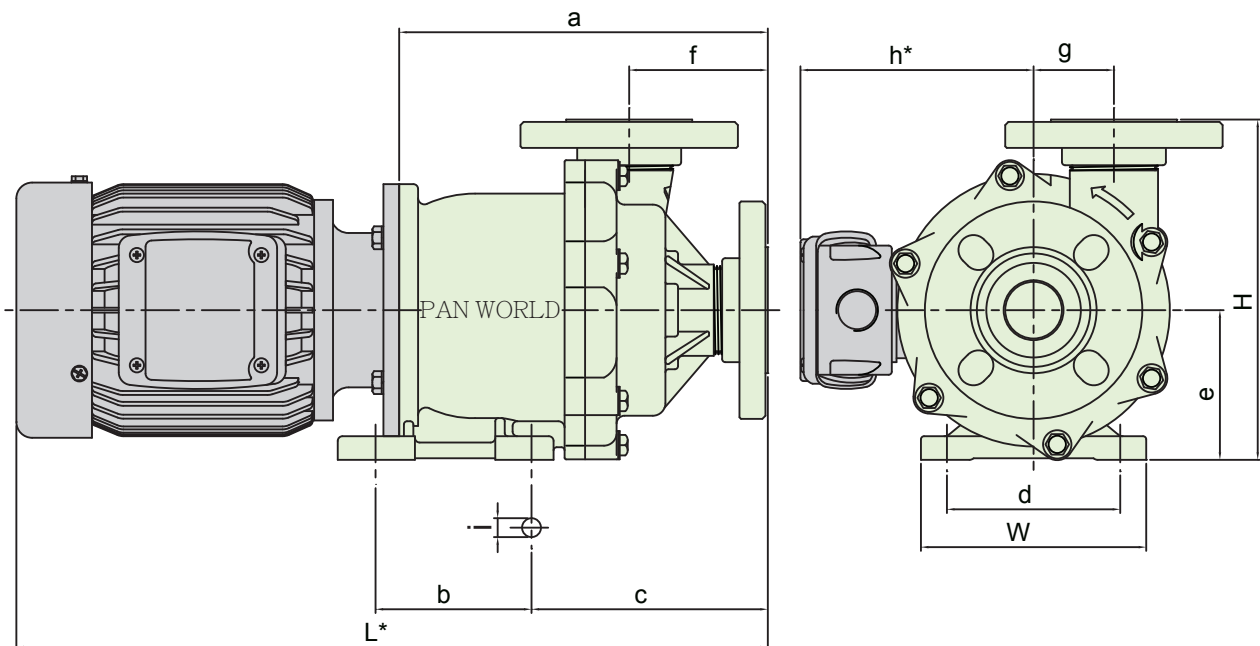

Dimensions in mm

MODEL	W	H	L*	a	b	c	d	e	f	g	h	i
350 PW / PW-F	157	257	472	232.5	130	161	130	115	88	77.5	138.5	12
351 PW / PW-F	160	257	470	240	130	170	130	115	88	77.5	145	12
352 PW / PW-F	160	242	505.5	222.5	132	155	130	120	78	57	149	12
353 PW / PW-F	160	242	505.5	222.5	132	155	130	120	78	57	149	12
400 PW / PW-F	140	216	473	233	98	150	110	95	87	51	151	12
401 PW / PW-F	160	254	488	256	130	184	130	115	102.5	57.5	160	12
402 PW / PW-F	260	255	620	305	200	158	208	115	89	65	176	14
403 PW / PW-F	260	255	620	305	200	158	208	115	89	65	176	14
405 PW / PW-F	260	270	689	326	200	158	208	130	89	65	208	14
505 PW / PW-F	260	319	650.5	287.5	300	123.2	220	162	89.5	60	208	14
507 PW / PW-F	260	319	676.5	311.5	300	123.2	220	162	89.5	60	252	14
655 PW / PW-F	260	360	723	360	270	240	210	175	118	85	208	14
657 PW / PW-F	260	360	745	380	270	240	210	175	118	85	252	14
6510 PW / PW-F	260	360	745	380	270	240	210	175	118	85	252	14
6515 PW / PW-F	350	385	918.5	408.5	270	240	300	200	118	85	285	14

Remarks :

1. This size in the table is shown with JIS motor.
2. Over all size & construction may be changed without notice.
3. * Depending on type of motor used.

PS-K Series (Fluorine Resin)

- Precision injection part, Fluorine Resin.
- 9 models with flow rates up to 120 lit/min and discharge head of 25 m.
- Able to handle almost all types of chemical and temperature up to 80°C.
- Available in hose , threaded or flange connections.



Specification table

Model	Connection Method				Performance M-L/Min , 50~60Hz		Motor
	Hose (mm) In x Outlet	Thread (") In x Outlet	Union (A) In x Outlet	Flange (A) In x Outlet	Max total head- max discharge	Specified head- Specified discharge	Output x Input (W)
NH-200PS-K	26 x 26	NPT1 x 1,G1 x 1	20 x 20	25 x 25	7.5-70 / 7.5-70	5.5-50 / 5.5-50	150-290
NH-200PS-K-3	26 x 26	NPT1 x 1,G1 x 1	20 x 20	25 x 25	7.5-70 / 7.5-70	5.5-50 / 5.5-50	150-290
NH-200PS-Z-K	26 x 26	NPT1 x 1,G1 x 1	20 x 20	25 x 25	12.5-35 / 16-37	9-20 / 8-30	150-290
NH-200PS-Z-K-3	26 x 26	NPT1 x 1,G1 x 1	20 x 20	25 x 25	12.5-35 / 16-37	9-20 / 8-30	150-290
NH-250PS-K	26 x 26	NPT1 x 1,G1 x 1	20 x 20	25 x 25	11.5-80 / 11.5-80	8.5-50 / 8.5-50	250-390
NH-250PS-K-3	26 x 26	NPT1 x 1,G1 x 1	20 x 20	25 x 25	11.5-80 / 11.5-80	8.5-50 / 8.5-50	250-390
NH-250PS-K-3E	26 x 26	NPT1 x 1,G1 x 1	20 x 20	25 x 25	12.5-120 / 14-120	9-65 / 9-80	JEM-0.2kW
NH-300PS-K	26 x 20	NPT1 x 3/4,G1 x 3/4	20 x 16	---	20-50 / 25-50	16-50 / 21-50	330-460
NH-300PS-K-3	26 x 20	NPT1 x 3/4,G1 x 3/4	20 x 16	---	20-50 / 25-50	16-50 / 21-50	330-460

Performance curve

Nominal speed : 2,700 r.p.m

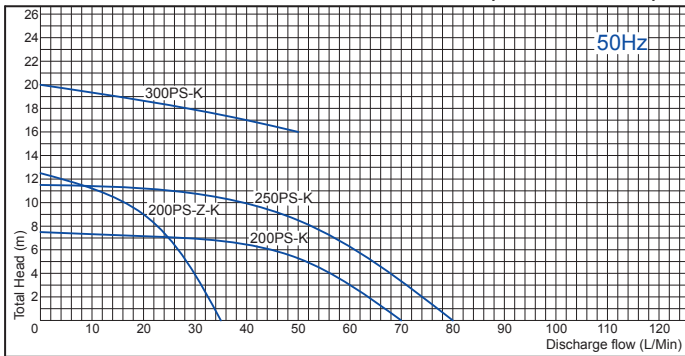

Nominal speed : 3,200 r.p.m

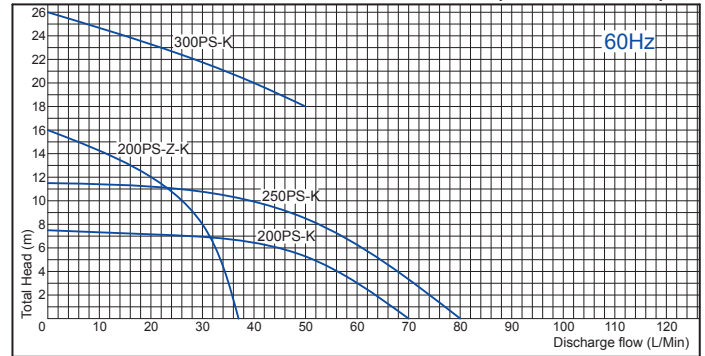

Installation dimension

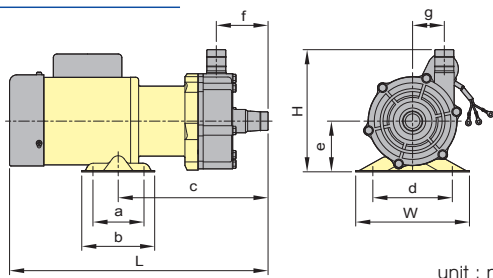

unit : mm

MODEL	W	H	L	a	b	c	d	e	f	g
NH-200PS-K	156	165	355	70	100	205	110	66	70	43.5
NH-200PS-K-3	156	165	345	70	100	205	110	66	70	43.5
NH-200PS-Z-K	156	165	355	70	100	205	110	66	70	43.5
NH-200PS-Z-K-3	156	165	345	70	100	205	110	66	70	43.5
NH-250PS-K	156	165	365	70	100	195	110	66	70	43.5
NH-250PS-K-3	156	165	355	70	100	195	110	66	70	43.5
NH-300PS-K	160	175	385	80	110	200	140	75	55	59
NH-300PS-K-3	160	175	375	80	110	200	140	75	55	59

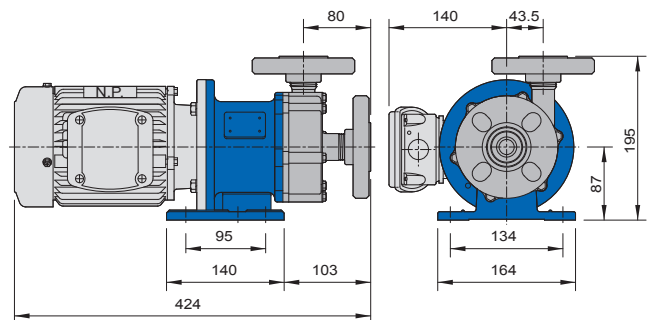

Installation dimension for NH-250PS-K-3E in mm

PW-K Series (Fluorine Resin) Sealless Magnetic Drive Pump

- Precision injection part, Fluorine Resin.
- 9 models with flow rates up to 550 lit/min and discharge head of 36.5m.
- Able to handle almost all types of chemical and temperature of up to 80°C.
- Adaptable with standard IEC motor, 0.37 to 3.7 kW.

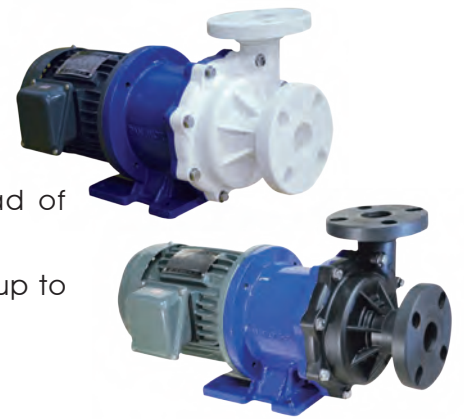

Type indication

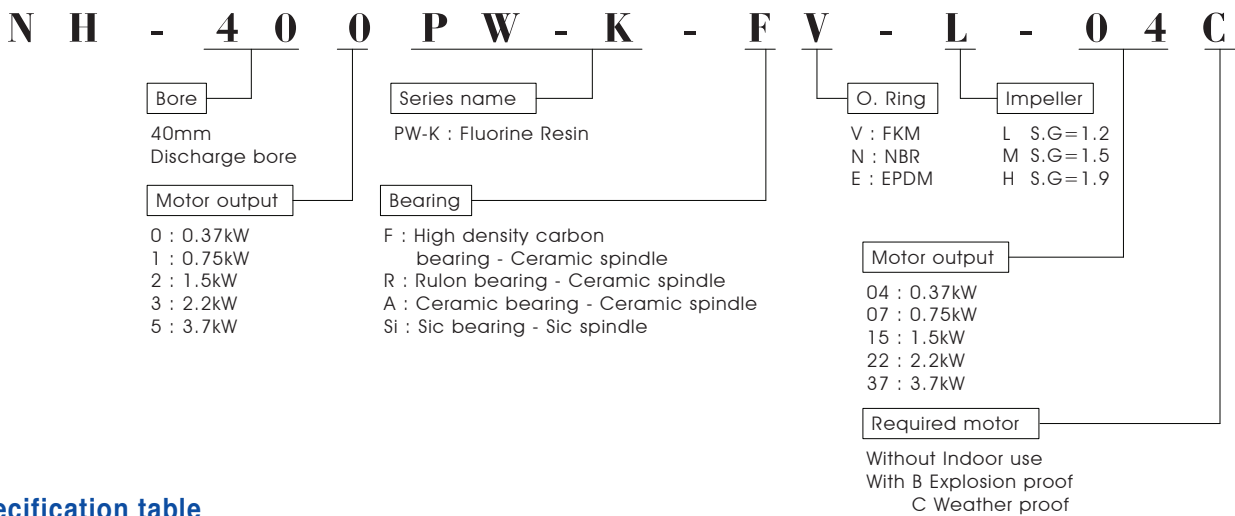

Specification table

Model	Connection Method		Pump performance at specified point(M-L/Min)			Applicable Motor Output(kW)
	Outlet(mm)	Inlet(mm)	Specific Gravity	50Hz	60Hz	
NH-350 PW-K	25	25	1.2	10.0 - 80	11.0 - 80	0.37
			1.5	11.0 - 40	11.0 - 50	
			1.9	6.0 - 50	7.0 - 60	
NH-351 PW-K	25	25	1.2	15.0 - 100	17.0 - 80	0.75
			1.5	12.4 - 80	14.5 - 70	
			1.9	12.0 - 80	14.5 - 20	
NH-352 PW-K	32	32	1.2	23.0 - 100	27.0 - 100	1.5
			1.5	21.0 - 100	25.0 - 100	
			1.9	18.0 - 100	21.0 - 100	
NH-353 PW-K	32	32	1.2	24.0 - 150	32.0 - 120	2.2
			1.5	22.0 - 150	29.0 - 120	
			1.9	19.0 - 150	25.0 - 120	
NH-400 PW-K	40	40	1.2	7.4 - 135	8.0 - 110	0.37
			1.5	6.5 - 135	5.2 - 135	
			1.9	4.7 - 120	3.9 - 120	
NH-401 PW-K	40	40	1.2	10.0 - 180	9.5 - 180	0.75
			1.5	8.5 - 160	8.8 - 160	
			1.9	6.0 - 175	5.2 - 175	
NH-402 PW-K	40	50	1.2	16.0 - 260	15.5 - 260	1.5
			1.5	13.0 - 240	13.5 - 240	
			1.9	10.0 - 280	7.9 - 280	
NH-403 PW-K	40	50	1.2	17.0 - 330	15.0 - 330	2.2
			1.5	15.0 - 310	16.3 - 310	
			1.9	14.0 - 280	13.0 - 280	
NH-405 PW-K	40	50	1.2	24.5 - 390	20.5 - 390	3.7
			1.5	20.5 - 310	20.3 - 350	
			1.9	15.2 - 220	19.3 - 290	

PW-K Series

PW-K series performance curve

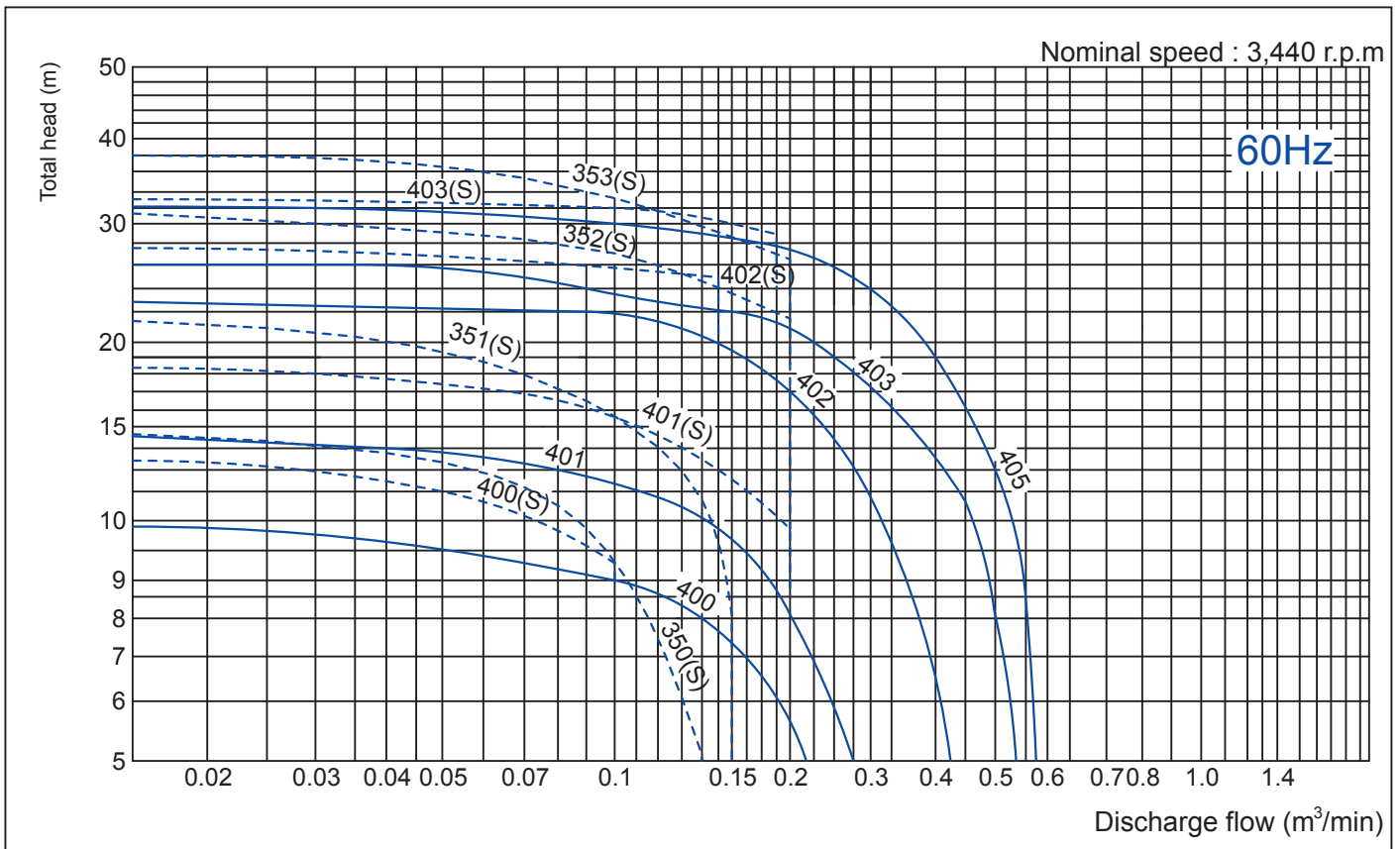
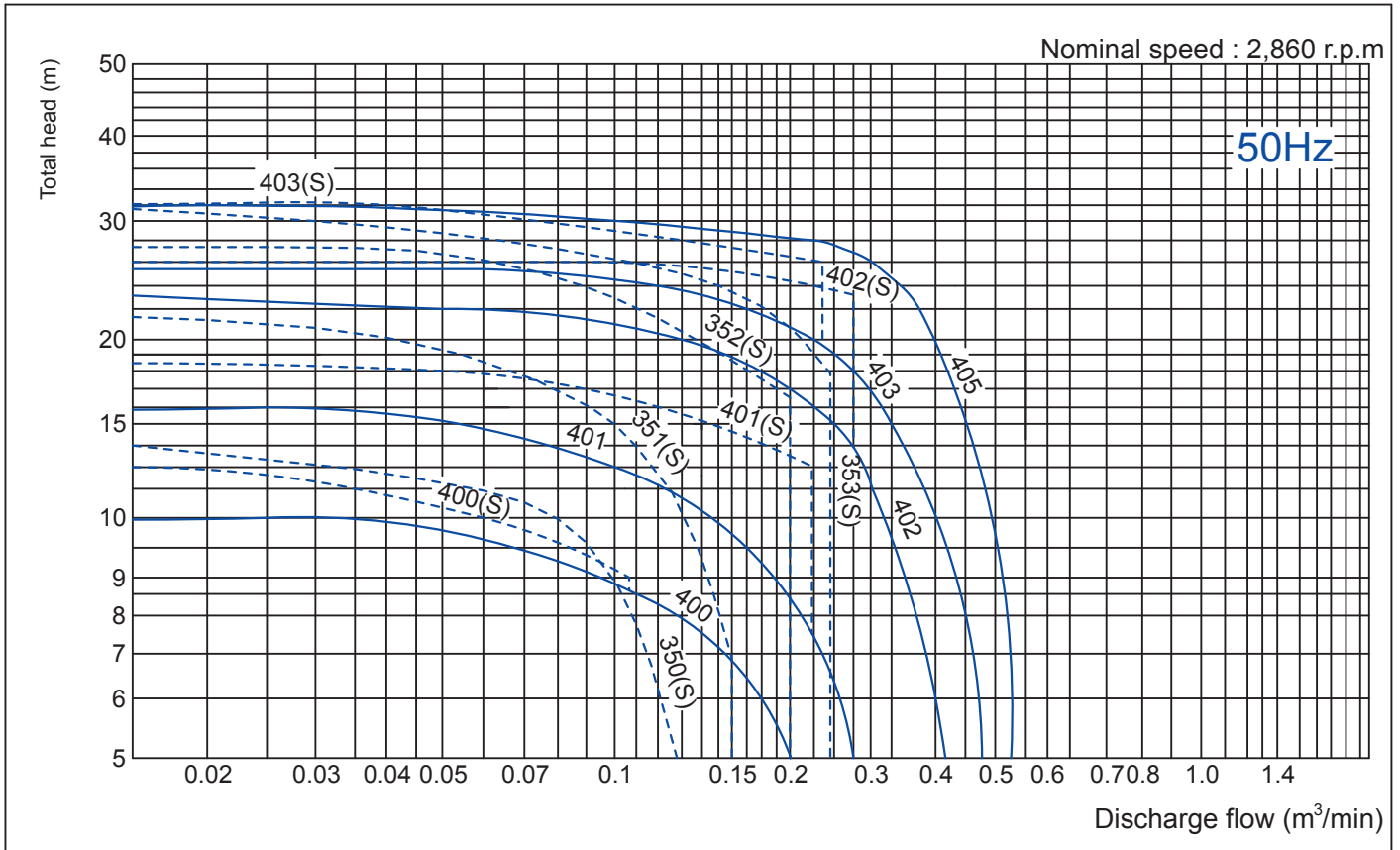

PW-K Series Parts List

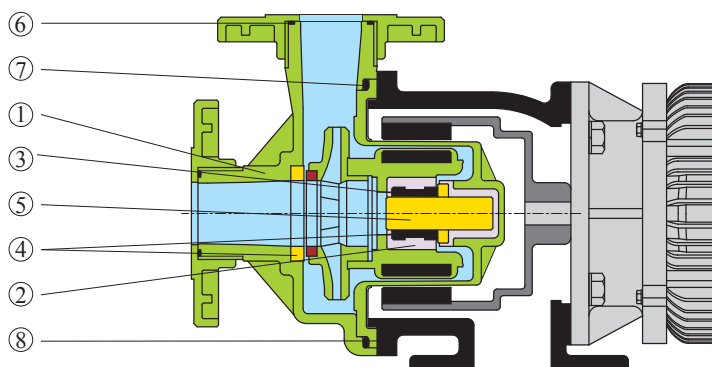

Part name	PW-K Series				
	FV	RV	AV	FN	SI
1. Casing	Fluorine Resin				
2. Holder	ETFE				
3. Bearing	H.D. Carbon	Rulon	Ceramic	H.D. Carbon	Sic
4. Thrust pad	Ceramic				Sic
5. Spindle	Ceramic	Sic	Ceramic	Sic	
6. O ring	FKM		NBR	FKM	
7. O ring	FKM		NBR	FKM	
8. Bracket	Grey cast iron				

Installation dimension

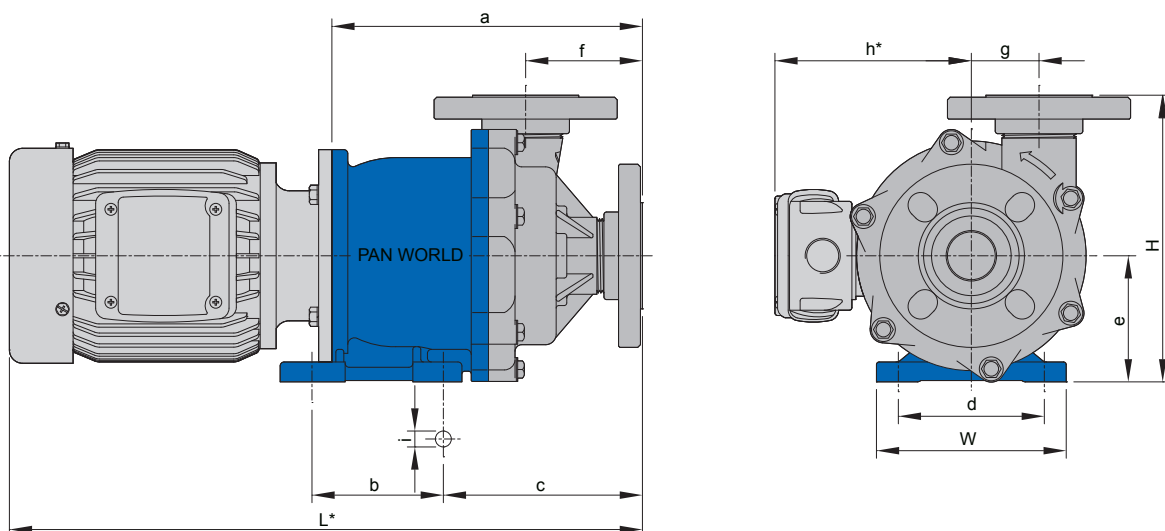

Dimensions in mm

MODEL	W	H	L*	a	b	c	d	e	f	g	h	i
NH-350PW-K	157	257	472	232.5	130	161	130	115	88	77.5	138.5	12
NH-351PW-K	160	257	470	240	130	170	130	115	88	77.5	145	12
NH-352PW-K	160	242	505.5	222.5	132	155	130	120	78	57	149	12
NH-353PW-K	160	242	505.5	222.5	132	155	130	120	78	57	149	12
NH-400PW-K	140	216	473	233	98	150	110	95	87	51	151	12
NH-401PW-K	160	254	488	256	130	184	130	115	102.5	57.5	160	12
NH-402PW-K	260	255	620	305	200	158	208	115	89	65	176	14
NH-403PW-K	260	255	620	305	200	158	208	115	89	65	176	14
NH-405PW-K	260	270	689	326	200	158	208	130	89	65	208	14

PX-SP Series (Glass Fiber reinforced PP) Compact Magnetic Driven Pump With Self Priming Chamber

- Suitable for application of negative suction lift head.
- 6 models with flow rate up to 50 lit/min.
- Offering ceramic bearing & ceramic spindle as wetted end parts.
- Standard connections available in hose, thread and union.
- 1.2 m suction lift at S.G. 1.0 is available.
- Top mount on to drum can is acceptable for replacement of drum pump.



Pump performance curve

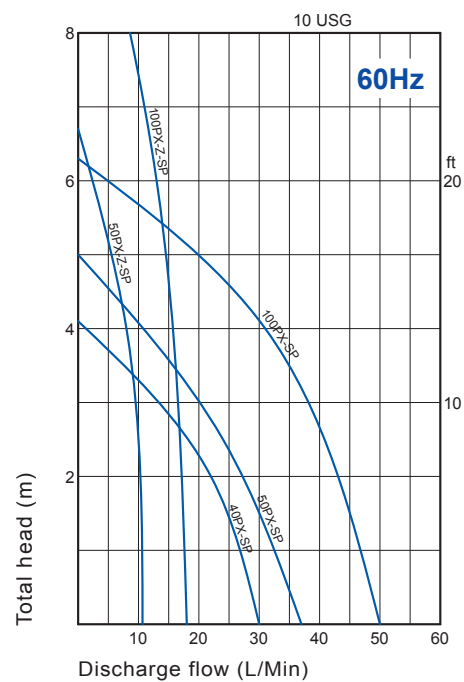
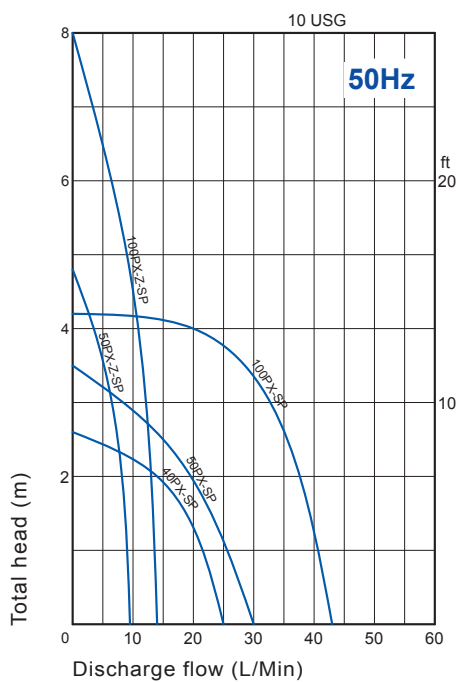

Specification table

Nominal speed : 2,500/3,000 r.p.m

Model	Connection method			Performance M-L/min, 50~60Hz		Max Suction Lift Head (m)	Motor
	Hose(mm)	Thread(″)	Union(A)	Max total head-max discharge	Specified head-specified discharge		Output x Input (W)
	In x Outlet	In x Outlet	In x Outlet				
40PX-SP	18 x 18	G3/4 x 3/4	16 x 16	2.6-25.0 / 4.1-30.0	2.0-14.0 / 2.0-22.0	1.2	20 - 40 / 45
50PX-Z-SP	18 x 18	G3/4 x 3/4	16 x 16	4.8-9.5 / 6.7-11.0	4.0-3.5 / 4.0-8.0	1.2	20 - 40 / 55
50PX-SP	20 x 20	G3/4 x 3/4	16 x 16	3.5-30.0 / 5.0-37.0	2.5-15.0 / 2.5-24.0	1.2	45 - 65 / 90
100PX-Z-SP	18 x 18	G3/4 x 3/4	16 x 16	8.0-14.0 / 11.0-18.0	5.0-9.0 / 6.0-13.0	1.2	45 - 80 / 95
100PX-SP	20 x 20	G3/4 x 3/4	16 x 16	4.2-43.0 / 6.3-50.0	4.2-20.0 / 4.0-31.0	1.2	65 - 90 / 120

PS-SP Series (Glass Fiber reinforced PP)

Compact Magnetic Driven Pump With Self Priming Chamber



- Suitable for application of negative suction lift head.
- 7 models with flow rate up to 120 lit/min.
- Offering the combination of ceramic bearing & ceramic spindle and combination of Sic as wetted end parts.
- Standard connections available in hose, thread, flange and union.
- 2.2 m suction lift at S.G. 1.0 is available.
- Top mount on to drum can is acceptable for replacement of drum pump.

Pump performance curve

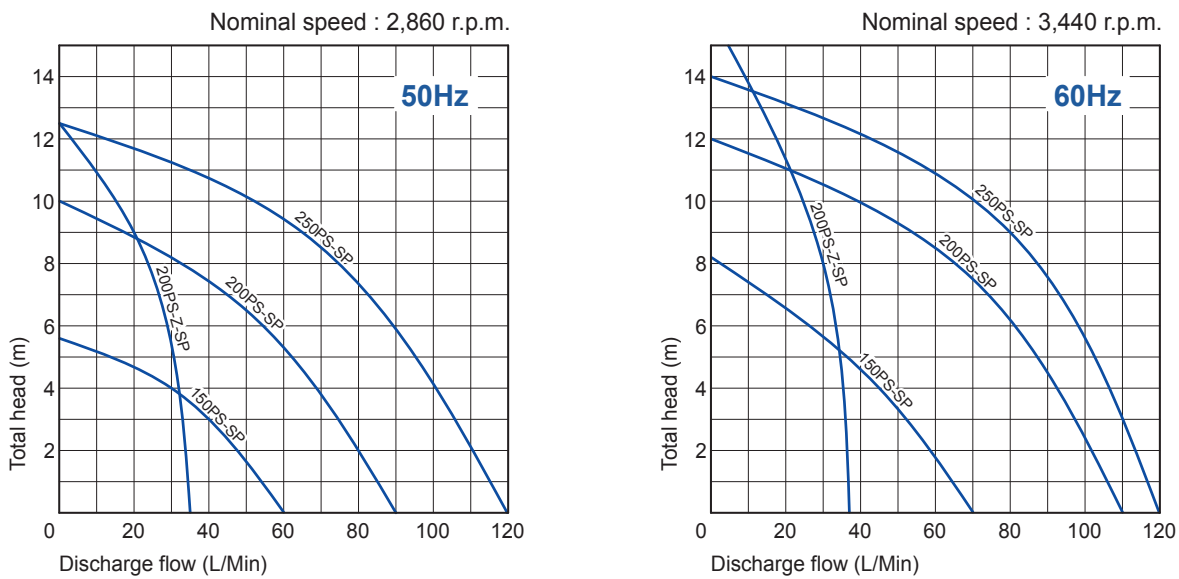

Specification table

Nominal speed 2,500/3,000 r.p.m

Model	Connection method				Performance M-L/min, 50~60Hz		Max Suction Lift Head (m)	Motor Output x Input (W)	Net Weight (Kg)
	Hose(mm)	Thread(″)	Union(A)	Flange (A)	Max total head-max discharge	Specified head-specified discharge			
	In x Outlet	In x Outlet	In x Outlet	In x Outlet					
150PS-SP	26 x 26	NPT1x1,G1x1	20 x 20	25 x 25	5.6-60 / 8.2-70	4-30 / 4-45	2.2	90-170	6
200PS-Z-SP	26 x 26	NPT1x1,G1x1	20 x 20	25 x 25	12.5-35 / 16-37	9-20 / 8-30	2.2	150-290	8
200PS-SP	26 x 26	NPT1x1,G1x1	20 x 20	25 x 25	10-90 / 12-110	6.5-50 / 7.5-70	2.2	150-290	8
200PS-SP-3	26 x 26	NPT1x1,G1x1	20 x 20	25 x 25	10-90 / 12-110	6.5-50 / 7.5-70	2.2	150-290	8
250PS-SP	26 x 26	NPT1x1,G1x1	20 x 20	25 x 25	12.5-120 / 14-120	9-65 / 9-80	2.2	250-390	8
250PS-SP-3	26 x 26	NPT1x1,G1x1	20 x 20	25 x 25	12.5-120 / 14-120	9-65 / 9-80	2.2	250-390	10
250PS-SP-3E	26 x 26	NPT1x1,G1x1	20 x 20	25 x 25	12.5-120 / 14-120	9-65 / 9-80	2.2	JEM-0.2kW	15

PW-SP Series

Self-Priming Type Magnetic Drive Pump

- Precision injection part, glass-fiber reinforced PP.
- Advanced design and rugged construction to minimise effect of cavitation or operational error.
- Available in 2 models with max flow rate of 330 lit/min.
- Max suction lift is 1m.
- Adaptable with standard IEC Standard motor.

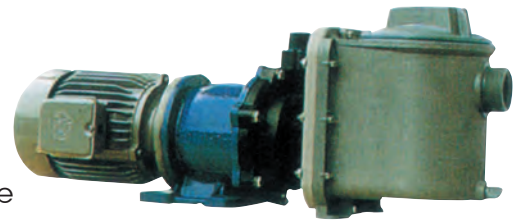

Specification table

Model	Nominal Flange Size Out x in (mm)	Max total head- max discharge (M-L/Min)	Specified head- specified discharge (M-L/Min)	Allowable suction Lift (m) at S.G.1.0	Applicable IEC motor (kW)
NH-400PW-SP	40 x 40	7.88-202.5	7.13-90 / 6.38-90	1.0	0.37
NH-401PW-SP	40 x 40	12.75-270 / 13.5-270	11.03-105 / 10.65-105	1.0	0.75

Pump performance curve

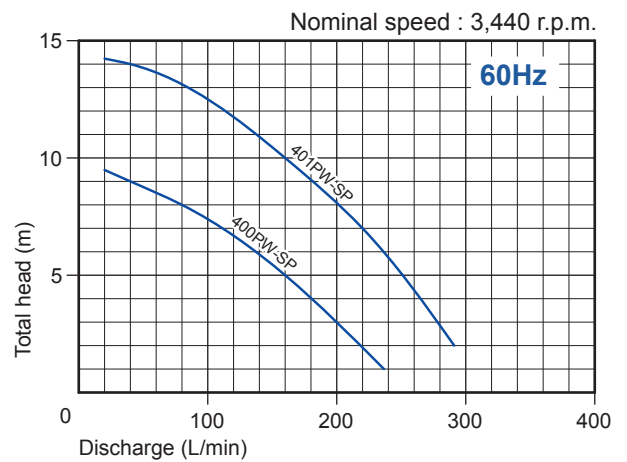
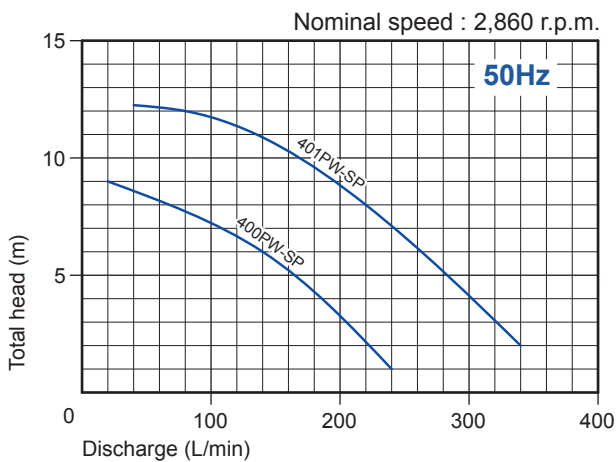

Installation dimension (for PW-SP Series)

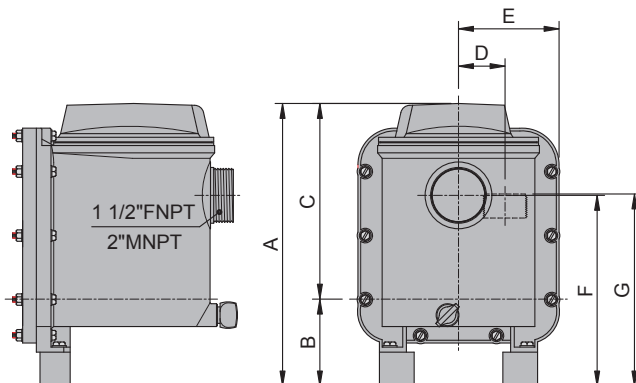

Dimension

Model	A	B	C	D	E	F	G
SP-400	309	95	214	51	220	207	210
SP-401	329	115	214	57.5	220	227	250

PS-N Series (Glass-fiber reinforced PP)
PS-N-K Series (Fluorine Resin)
Self-Priming Magnetic Drive Pump



- Precision injection part, glass-fiber reinforced PP or Fluorine Resin.
- Advanced design with gas and liquid separated construction.
- Max suction lift head up to 2 m.

Type Indication

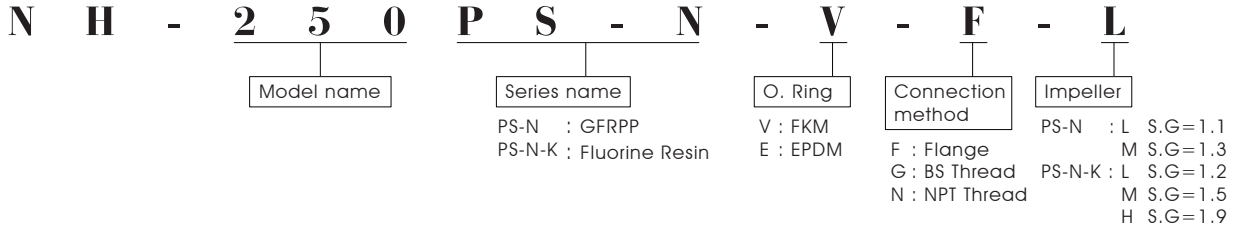

Specification table

Model	Connection method		S.G.	Performance , 50/60Hz		Max Self Priming Lift head at S.G 1.0 (m)	Motor kW 2860/3440
	Flange(mm)	Thread(")		Capacity-discharge head at specified point (l/min at m)	Max capacity - max discharge (L/Min - m)		
	In x Outlet	In x Outlet					
NH-250PS-N	25 x 25	1x1	1.1	60 at 8.5 / 60 at 9.0	100-12 / 100-12.5	2	0.25
			1.3	60 at 6.0 / 60 at 6.5	90-10.0 / 90-10.0		
NH-250PS-N-K	25 x 25	1x1	1.2	60 at 8.0 / 60 at 8.5	100-11.5 / 100-12.0	2	0.25
			1.5	60 at 7.0 / 60 at 7.5	100-9.5 / 100-10.0		
			1.9	60 at 6.0 / 60 at 6.5	100-8.5 / 100-8.5		

Note : 1. Max self-priming lift head is shown when horizontal pipe length of section inlet is max 0.5m.
 2: Max self-priming lift head is S.G. at 1.0

Pump performance curve

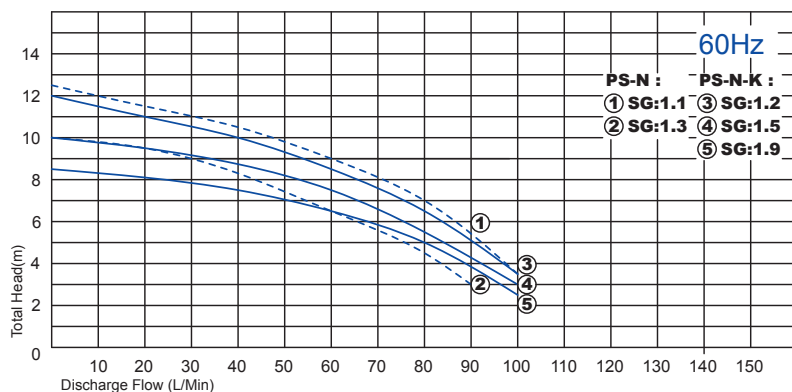
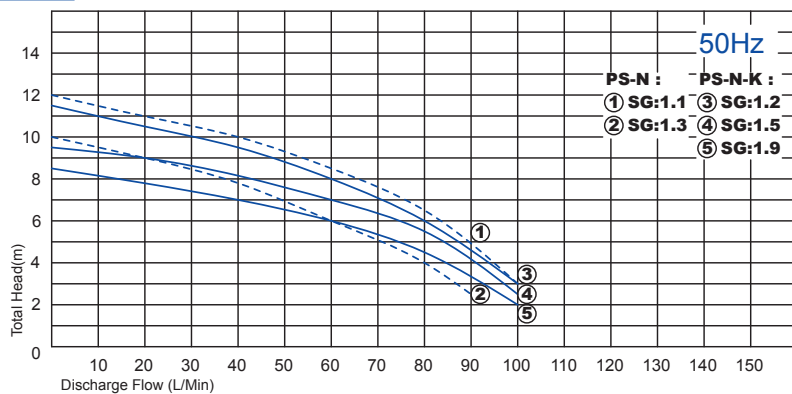

PS-N Series
PS-N-K Series
Parts List

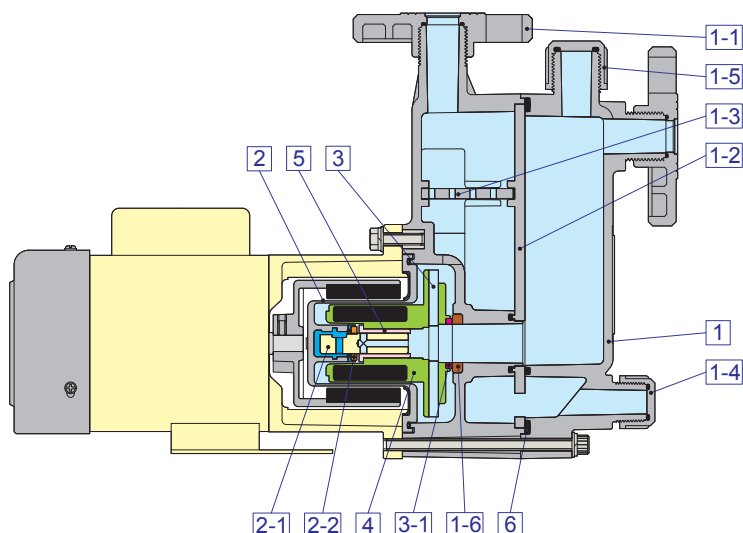

Name of part	Model	NH-250PS-N		NH-250PS-N-K	
		V	E	RV	RE
1. Self-priming chambers		GFRPP		Fluorine Resin	
1-1. Flange					
1-2. Telescopic piece					
1-3. Filter					
1-4. Drain cap					
1-5. Filler cap					
1-6. Thrust pad		99.5% Alumina ceramic		99.5% Alumina ceramic	
2. Rear casing		GFRPP		ETFE	
2-1. Spindle		99.5% Alumina ceramic		99.5% Alumina ceramic	
2-2. Rear thrust pad		99.5% Alumina ceramic		99.5% Alumina ceramic	
3. Impeller		GFRPP		ETFE	
3-1. Mouth ring		Rulon [®]		Rulon [®]	
4. Magnet capsule		GFRPP		ETFE	
5. Bearing		Rulon [®]		Rulon [®]	
6. Gasket		FKM	EPDM	FKM	EPDM
7. O. Rings		FKM	EPDM	FKM	EPDM

Installation dimension

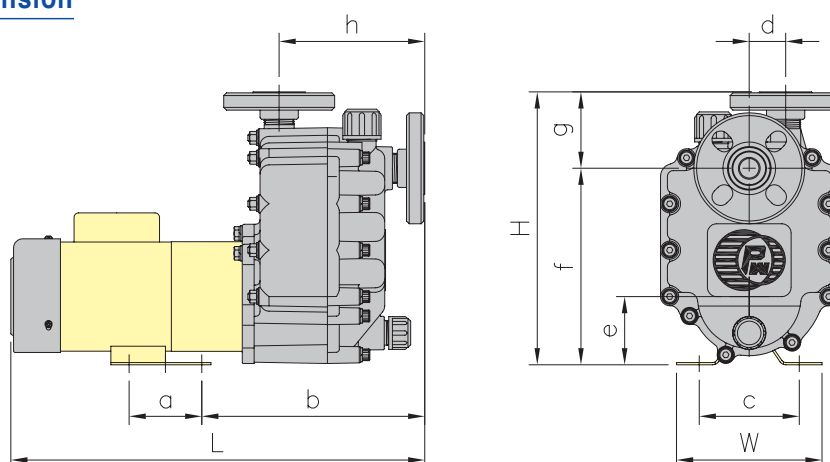

Dimensions in mm

Model	W	H	L	a	b	c	d	e	f	g	h
NH-250PS-N / 250PS-N-K	160	300	455	80	245	110	40	75	216	84	160
NH-250PS-N-3 / 250PS-N-K-3	160	300	445	80	245	110	40	75	216	84	160

Remark : 1. PS-N-K/PS-N-K-3 The size in above table is shown with original motor.

PW-N Series (Glass-fiber reinforced PP)
PW-N-K Series (Fluorine Resin)
Self-Priming Magnetic Drive Pump



- Precision injection part, glass-fiber reinforced PP or Fluorine Resin.
- Advanced design with gas and liquid separated construction.
- Heavy duty, Reliability.
- Available in 10 models with max flow rate of 600 lit/min.
- Max suction lift head up to 4 m.
- Adaptable with world wide motor as standard and pipe connection.

Type Indication

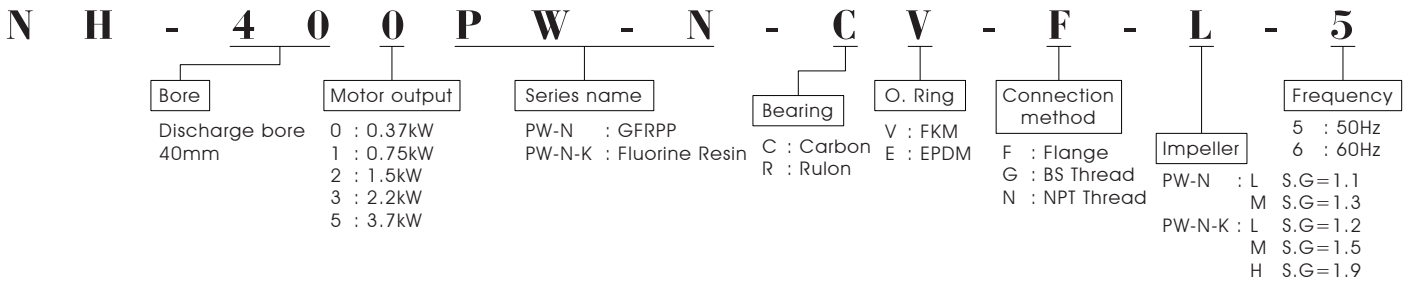

Specification table

Model	Connection Method		S.G	Performance , 50/60Hz		Max Self Priming Lift head at(m)	Motor kW 2860/3440
	Flange (mm) In x Outlet	B. Thread (") In x Outlet		Capacity-discharge head at specified point (l/min at m)	Max capacity - max discharge (L/Min - m)		
NH-400PW-N	40 x 40	1 1/2" x 1 1/2"	1.1	140 at 7 / 140 at 6	240-10.5 / 240-9.5	3	0.37
			1.3	160 at 5 / 120 at 6	200-8.5 / 200-8.5		
NH-401PW-N	40 x 40	1 1/2" x 1 1/2"	1.1	200 at 10 / 200 at 8	320-16 / 320-15	3.3	0.75
			1.3	160 at 10 / 160 at 9	290-14 / 290-12.5		
NH-402PW-N	50 x 40	2" x 1 1/2"	1.1	250 at 16 / 250 at 16	470-24.5 / 470-20.5	4	1.5
			1.3	265 at 14 / 265 at 13	450-22 / 450-19		
NH-403PW-N	50 x 40	2" x 1 1/2"	1.1	280 at 21 / 290 at 19	570-26 / 570-23	4	2.2
			1.3	240 at 18 / 240 at 18	550-23 / 550-21		
NH-405PW-N	50 x 40	2" x 1 1/2"	1.1	330 at 25 / 330 at 26	600-32 / 600-32.5	4	3.7
			1.3	330 at 25 / 320 at 23	600-32 / 570-31		
NH-400PW-N-K	40 x 40	1 1/2" x 1 1/2"	1.2	140 at 6.5 / 140 at 6	240-10 / 240-9	3	0.37
			1.5	140 at 5.5 / 140 at 5.5	240-8.5 / 240-7.5		
			1.9	140 at 5 / 120 at 5.5	240-7.5 / 240-6.5		
NH-401PW-N-K	40 x 40	1 1/2" x 1 1/2"	1.2	170 at 10.5 / 180 at 10	320-15 / 320-14	3.3	0.75
			1.5	160 at 9.5 / 190 at 8	320-13 / 320-12		
			1.9	160 at 8 / 220 at 6.5	320-11 / 320-10.5		
NH-402PW-N-K	50 x 40	2" x 1 1/2"	1.2	210 at 17 / 200 at 17.5	470-23 / 470-19.5	4	1.5
			1.5	250 at 13.5 / 230 at 13	470-20 / 470-16.5		
			1.9	230 at 12 / 270 at 11.5	470-20 / 470-14		
NH-403PW-N-K	50 x 40	2" x 1 1/2"	1.2	360 at 17 / 360 at 16	570-24.5 / 570-21.5	4	2.2
			1.5	340 at 15 / 380 at 13	570-21 / 570-18.5		
			1.9	360 at 12.5 / 340 at 12	570-18 / 570-16		
NH-405PW-N-K	50 x 40	2" x 1 1/2"	1.2	330 at 24 / 330 at 24.5	600-30 / 600-30.5	4	3.7
			1.5	380 at 19 / 330 at 21	600-26 / 600-26.5		
			1.9	360 at 17 / 330 at 18	600-22 / 600-22.5		

PW-N Series
PW-N-K Series
 Pump performance curve

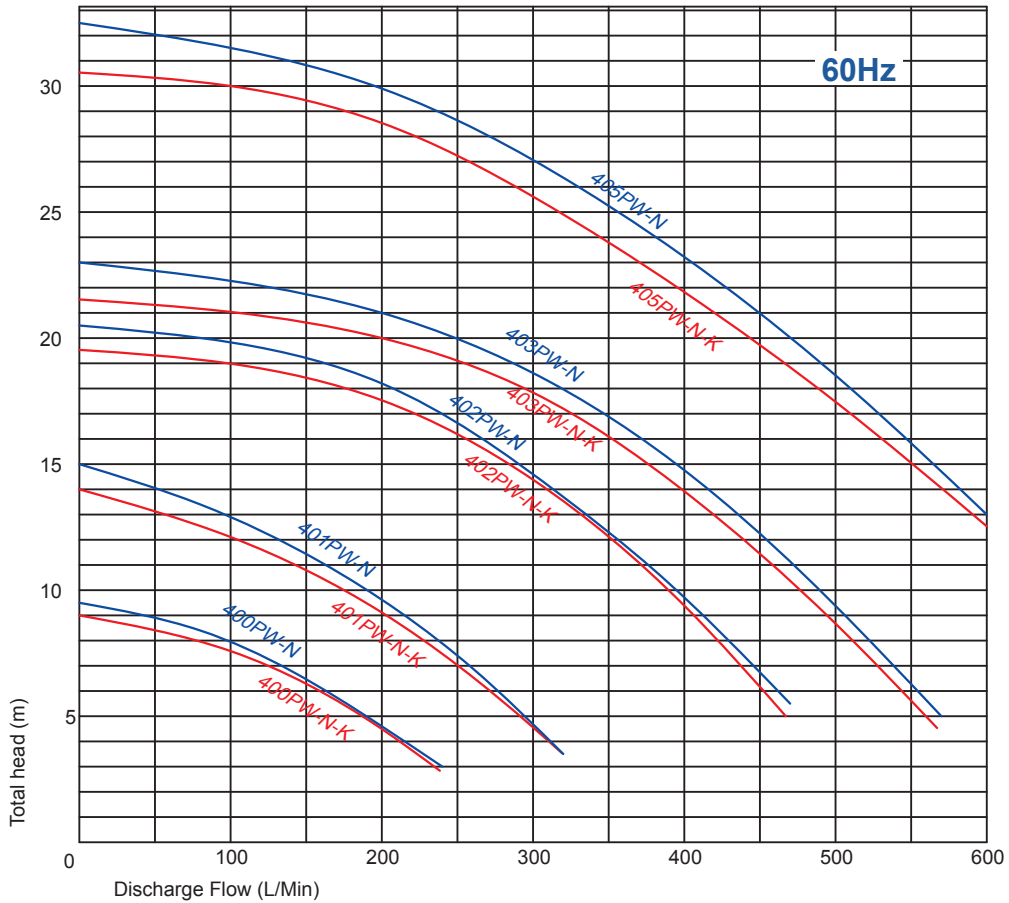
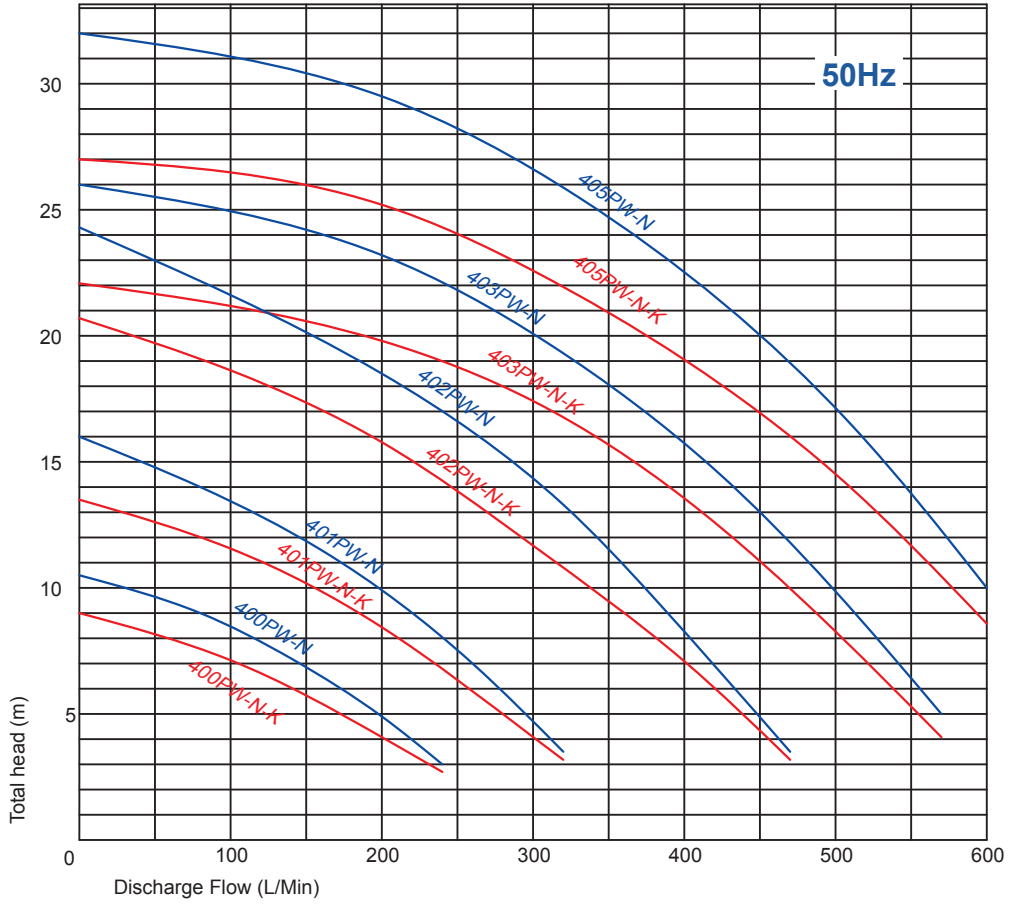

**PW-N Series
PW-N-K Series**
Parts List

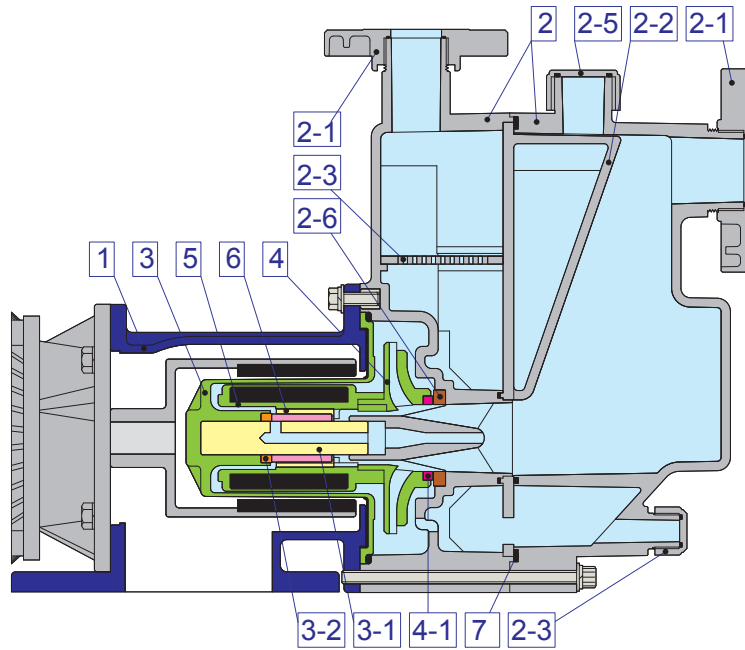

Model	NH-400/401/402/403/405PW-N		NH-400/401/402/403/405PW-N-K			
	CV	CE	RV	CV	RE	CE
Name of part	FC-20		FC-20			
1. Bracket						
2. Self-priming chambers	GFRPP		Fluorine Resin			
2-1. Flange						
2-2. Telescopic piece						
2-3. Filter						
2-4. Drain cap						
2-5. Filler cap						
2-6. Thrust pad	99.5% Alumina ceramic		99.5% Alumina ceramic			
3. Rear casing	GFRPP		ETFE			
3-1. Spindle	99.5% Alumina ceramic		99.5% Alumina ceramic			
3-2. Rear thrust pad	99.5% Alumina ceramic		99.5% Alumina ceramic			
4. Impeller	GFRPP		ETFE			
4-1. Mouth ring	Rulon LD		Rulon LD			
5. Magnet capsule	GFRPP		ETFE			
6. Bearing	Carbon		Rulon LD			
7. Gasket	FKM	EPDM	FKM		EPDM	
8. O. Rings	FKM	EPDM	FKM		EPDM	

Installation dimension

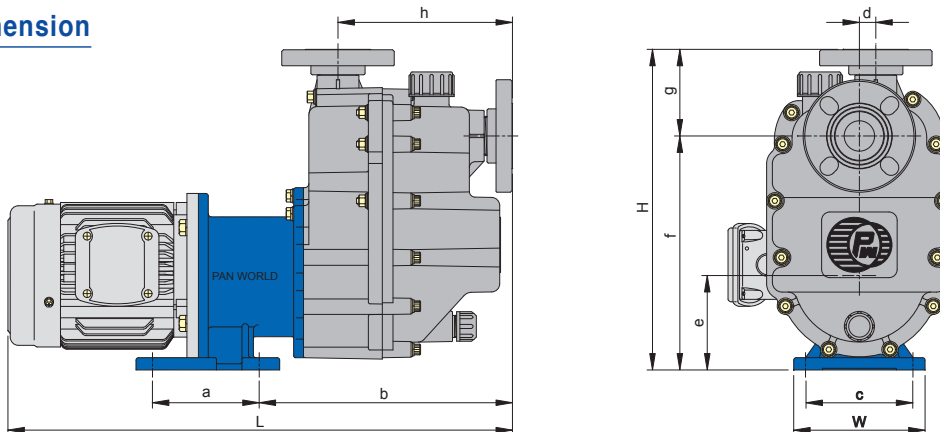

Dimensions in mm

Model	W	H	L	a	b	c	d	e	f	g	h
NH-400PW-N / 400PW-N-K	160	390	613	130	308	130	20	115	285	105	212
NH-401PW-N / 401PW-N-K	160	390	615	130	308	130	20	115	285	105	212
NH-402PW-N / 402PW-N-K	260	420	794	200	333	208	30	115	315	105	250
NH-403PW-N / 403PW-N-K	260	420	794	200	333	208	30	115	315	105	250
NH-405PW-N / 404PW-N-K	260	435	866	200	333	208	30	130	330	105	250

PW-C Series (ETFE-Lined Metal Profile) Heavy Duty Magnetic Drive Pumps For The Chemical Industry



- ETFE-lined pumps in cast iron exterior and Hastelloy C rear casing cover as reinforcement.
- Robust construction.
- 11 models with flow rates up to 1500 lit/min and discharge head of 42m.
- Can handle practically most chemicals and temperature up to 90°C.
- Adaptable to IEC Standard motor, 0.37 to 15 kW.
- Available in flange connections.

Type indication

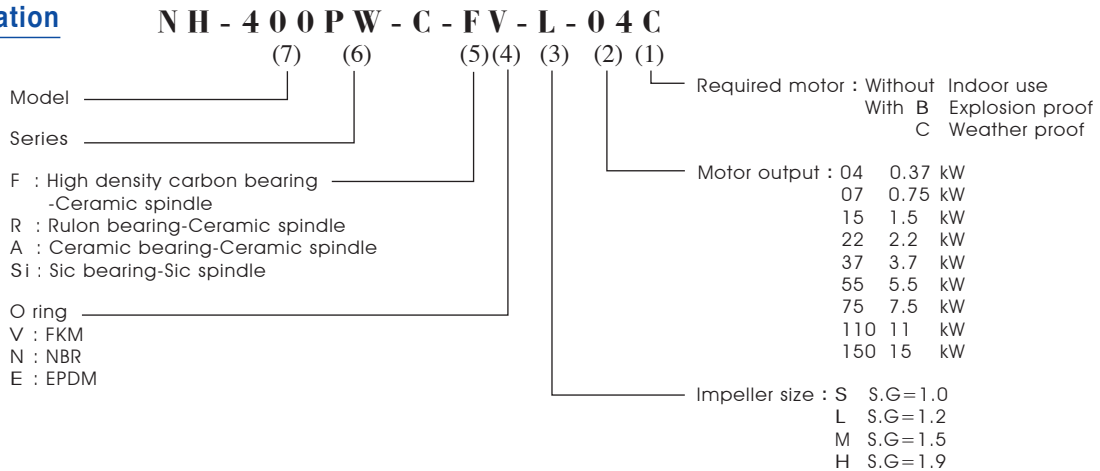

Specification table

Type	Flange size		Pump performance at specified point (M at L/Min)			Motor output (kW)	Net weight (Kg)
	Outlet(mm)	Inlet(mm)	Specific Gravity	50Hz	60Hz		
NH-250 PW-C	25	25	1.2	7.0 - 135	6.0 - 145	0.37	30
			1.5	5.8 - 140	5.5 - 135		
			1.9	4.7 - 115	3.9 - 115		
NH-401 PW-C	40	40	1.2	9.3 - 200	9.5 - 180	0.75	40
			1.5	7.6 - 190	8.7 - 160		
			1.9	7.7 - 170	6.2 - 140		
NH-402 PW-C	40	50	1.2	16.0 - 260	13.1 - 260	1.5	50
			1.5	14.0 - 260	13.2 - 260		
			1.9	11.0 - 240	10.9 - 220		
NH-403 PW-C	40	50	1.2	18.0 - 320	17.4 - 320	2.2	58
			1.5	15.0 - 300	13.8 - 320		
			1.9	13.5 - 260	14.5 - 260		
NH-405 PW-C	40	50	1.2	25.0 - 380	23.0 - 400	3.7	72
			1.5	22.5 - 350	20.3 - 350		
			1.9	20.0 - 290	15.2 - 400		
NH-505 PW-C	50	65	1.2	16.7 - 550	16.2 - 560	3.7	80
			1.5	13.0 - 450	13.0 - 390		
			1.9	10.0 - 400	11.7 - 360		
NH-507 PW-C	50	65	1.2	25.7 - 550	27.1 - 500	5.5	112
			1.5	16.3 - 480	15.1 - 500		
			1.9	14.4 - 400	13.7 - 400		
NH-657 PW-C	50	80	1.2	19.2 - 800	20.4 - 800	5.5	124
			1.5	15.4 - 650	14.6 - 700		
			1.9	12.5 - 550	10.8 - 600		
NH-6510PW-C	50	80	1.2	24.7 - 950	25.0 - 950	7.5	149
			1.5	20.0 - 800	19.5 - 720		
			1.9	17.0 - 710	15.7 - 710		
NH-6515PW-C	50	80	1.2	32.0 - 1100	28.8 - 900	11	185
			1.5	24.5 - 900	25.0 - 900		
			1.9	19.8 - 800	20.5 - 800		
NH-6520PW-C	50	80	1.2	---	39.0 - 1050	15	185
			1.5	---	24.0 - 1100		
			1.9	---	24.0 - 950		

PW-C Series Parts List

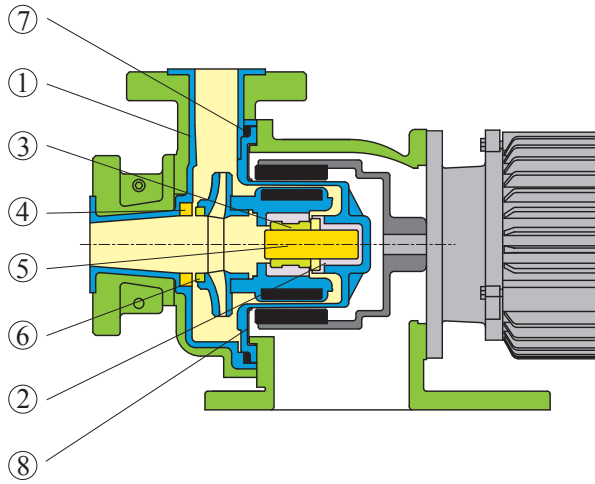

Part name	PW-C Series			
	FV	RV	AV	Si
1. Casing	Carbon fiber reinforced tetra fluorethylene			
2. Holder	Carbon fiber reinforced tetra fluorethylene			
3. Bearing	H.D. Carbon	Rulon	Ceramic	Sic ceramic
4. Thrust ring	High purity Ceramic			
5. Spindle	High purity Ceramic			
6. Mouth ring	PTFE based resin			
7. O ring	FKM			
8. Cover	Grey cast iron			

PW-C series performance curve

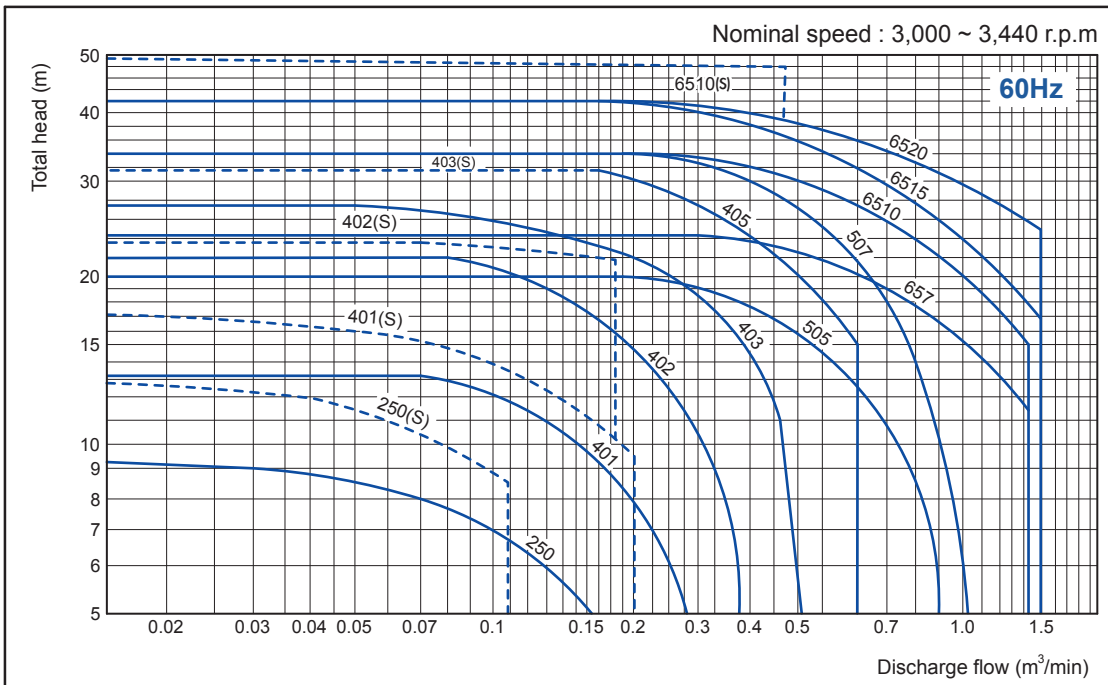
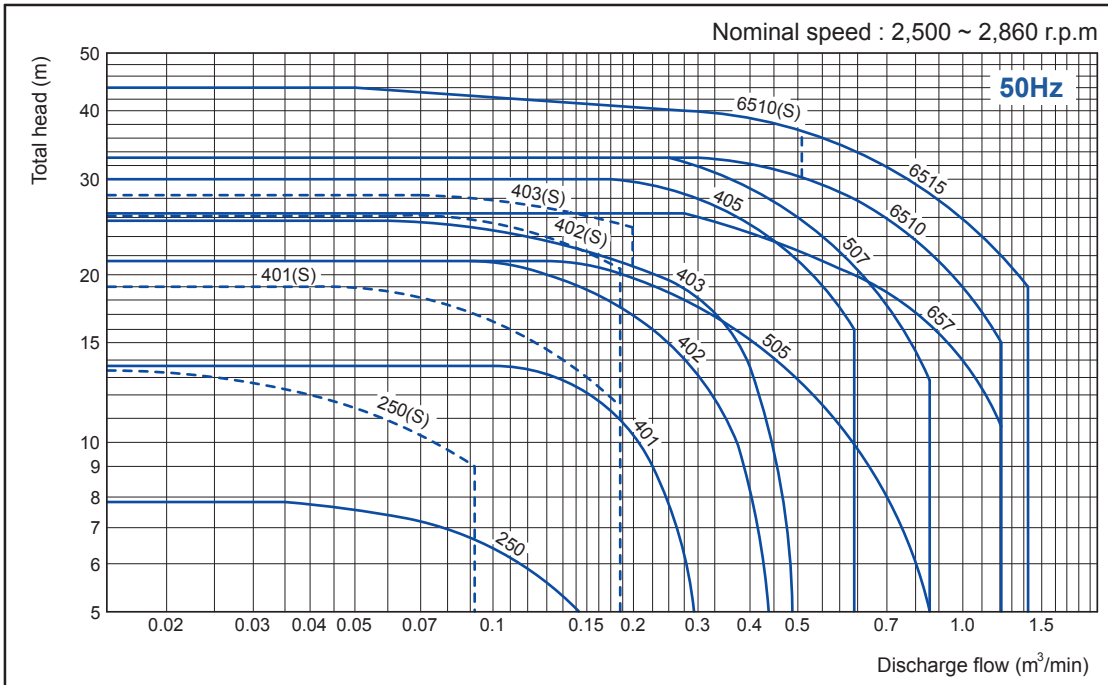

PW-C Series

Installation dimension

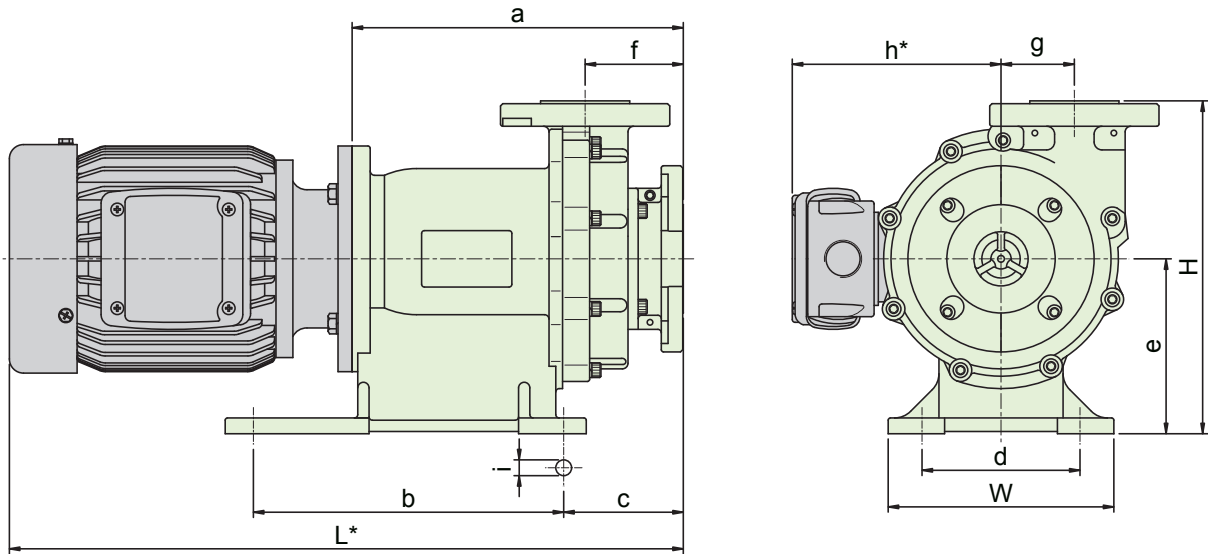

Dimensions in mm

Model	W	H	L*	a	b	c	d	e	f	g	h*	i
250PW-C	155	237	474	234	146	95	110	115	88	51	151	14
401PW-C	195	275	492	260	250	111	130	135	104.5	57.5	160	14
402PW-C	200	295	606	291	275	106	140	155	87	65	176	14
403PW-C	200	295	606	291	275	106	140	155	87	65	176	14
405PW-C	200	295	675.5	312.5	275	106	140	155	87	65	208	14
505PW-C	260	325	712	349	305	130	210	175	110	62	208	14
507PW-C	260	325	734	369	305	130	210	175	110	62	252	14
657PW-C	280	360	743	378	320	193	220	175	118	0	252	14
6510PW-C	280	360	743	378	320	193	220	175	118	0	252	14
6515PW-C	350	385	918	408	320	193	300	200	118	0	285	14
6520PW-C	350	385	918	408	320	193	300	200	118	0	285	14

Remarks:

1. JIS, ISO, NEMA or explosion motor is available.
2. Over all size & part construction will be changed without notice.
3. NH-657, 6510, 6515, 6520 are top centre discharge.
4. * Depending on type of motor used.

PW-XJ Series (ETFE-Lined Metal Profile)

ISO Standard Magnetic Drive Pumps for the Chemical Industry



- ETFE-lined pumps in cast iron exterior and Hastelloy C rear casing cover as reinforcement.
- Robust construction.
- 5 models with flow rates up to 600 lit/min and discharge head of 77m.
- Can handle practically most chemicals and temperature up to 90°C.
- Adaptable to IEC, JIS, CNS & NEMA-C Standard motor, 5.5 to 11 kW.
- Flanges are to ISO-16 Bar standard.

Specification table

Type	Flange size Outlet x inlet	Duty point 50/60Hz	Max point 50/60Hz	Power kW requirement
		M at L/min	M-L/min	
NH-40-140PW-XJ	ISO-16Bar 40A x 65A	20 at 417 / 31 at 417	25-600 / 36-600	3.5 / 5.0
-160PW-XJ		29 at 417 / 44 at 417	34-600 / 48-600	4.9 / 7.5
-180PW-XJ		40 at 417 / 60 at 417	44-600 / 63-600	7.5 / 11.0
-200PW-XJ		51 at 417 / 75 at 417	55-600 / 77-600	9.3 / 13.5
-210PW-XJ		53 at 417 / ---	60-600 / ---	10.5 / ----

Allowable S.G. and required motor output

Type	S.G : 1.0	S.G : 1.2	S.G : 1.5	S.G : 1.9
NH-40-140PW-XJ-□□-□-55-□	5.5kW	5.5kW	7.5kW	11 kW
NH-40-160PW-XJ-□□-□-75-□	7.5kW	7.5kW	11 kW	*11 kW
NH-40-180PW-XJ-□□-□-75-□	7.5kW	11 kW	11 kW	*11 kW
NH-40-200PW-XJ-□□-□-110-□	11 kW	11 kW	*11 kW	*11 kW
NH-40-210PW-XJ-□□-□-110-□	11 kW	11 kW	*11 kW	*11 kW

Note : 1. Pump mode with *mark requires trimming impeller diameter according to specific gravity, viscosity and applicable motor.

2. In case of pump performance curve at 60Hz according each specific, diameter of impeller should be trimmed.

Pump performance curve

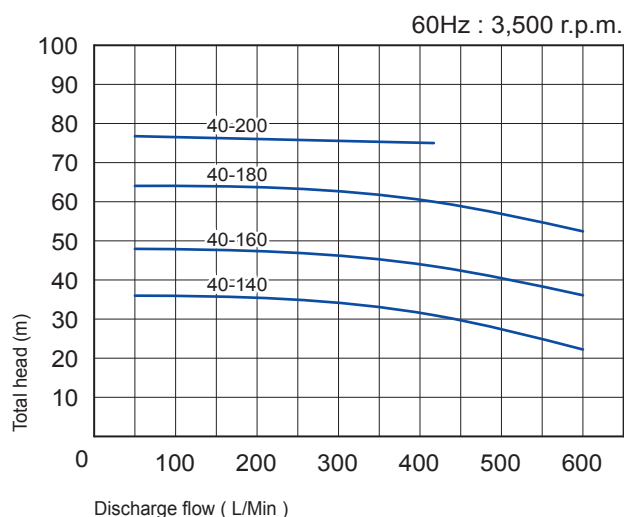
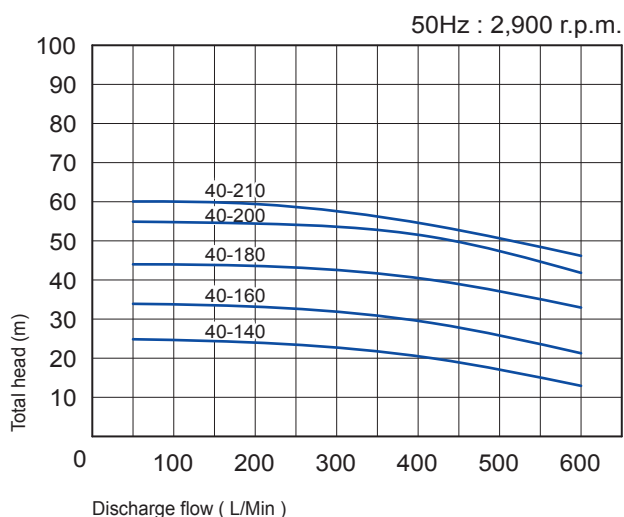

PG Series (ISO-5199 Co-Ni-mo Steel) Magnetic Drive Pumps

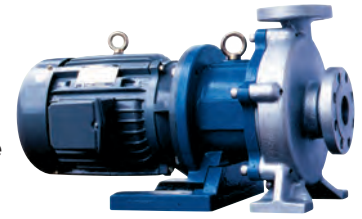

- SUS-316 and Sic wetted-end, magnetic drive pump in compliance with ISO/JIS Standard.
- 14 models with flow rates up to 550 lit/min and discharge head up to 60m.
- Suitable applications include pharmaceutical, reactor, and all types of solvent and alkaline.
- Modular construction of models to minimise parts.
- Applicable motors. IEC, JEM, CNS & NEMA-C, from 2.2kW to 15kW.
- Flanges are to ISO, JSI CNS & ANSI standard.

Specification table

50/60Hz

Model	Flange size Outlet x inlet	Duty point M at L/min	Max point M - L/min	Power requirement at duty point. kW
NH-32-100PG	32 × 50	12/15 at 215	15/19 - 300	2.2 / 4.2
NH-32-120PG	32 × 50	15/20 at 215	20/26 - 300	2.5 / 5.5
NH-32-140PG	32 × 50	20/27 at 215	27/35 - 300	3.1 / 7.3
NH-32-160PG	32 × 50	32/43 at 215	34/46 - 300	4.0 / 9.4
NH-32-180PG	32 × 50	41/50 at 215	43/58 - 300	5.9 / 11
NH-32-200PG	32 × 50	50/66 at 215	54/-- - 300	6.7 / ---
NH-32-210PG	32 × 50	55/71 at 215	60/-- - 300	7.5 / ---
NH-40-100PG	40 × 65	12/15 at 430	16/18 - 550	3.6 / 4.7
NH-40-120PG	40 × 65	15/19 at 430	21/25 - 550	4.4 / 6.5
NH-40-140PG	40 × 65	20/27 at 430	28/35 - 550	5.2 / 8.5
NH-40-160PG	40 × 65	32/42 at 430	35/47 - 550	6.1 / 10.1
NH-40-180PG	40 × 65	40/52 at 430	48/-- - 550	7.6 / ---
NH-40-200PG	40 × 65	50/65 at 430	55/-- - 550	8.6 / ---
NH-40-210PG	40 × 65	55/70 at 430	60/-- - 550	9.4 / ---

Allowable S.G. and required motor output

50/60Hz

Model	S.G.:1.0	S.G.:1.2	S.G.:1.5	S.G.:1.9
NH-32-100PG	2.2 / 5.5	3.7 / 5.5	3.7 / 7.5	3.7 / 11
NH-32-120PG	3.7 / 5.5	3.7 / 7.5	5.5 / 11	5.5 / 11
NH-32-140PG	3.7 / 5.5	3.7 / 11	5.5 / 11	7.5 / 11
NH-32-160PG	5.5 / 11	5.5 / 11	7.5 / 11	7.5 / *15
NH-32-180PG	7.5 / 11	7.5 / *15	11 / *15	*11 / ---
NH-32-200PG	7.5 / ---	7.5 / ---	11 / ---	--- / ---
NH-32-210PG	7.5 / ---	11 / ---	*11 / ---	--- / ---
NH-40-100PG	3.7 / 5.5	5.5 / 7.5	5.5 / 7.5	7.5 / 11
NH-40-120PG	5.5 / 7.5	5.5 / 11	7.5 / 11	11 / 11
NH-40-140PG	7.5 / 11	7.5 / 11	7.5 / 11	11 / *15
NH-40-160PG	7.5 / 11	7.5 / 11	7.5 / *15	*11 / ---
NH-40-180PG	11 / *15	11 / *15	*11 / ---	--- / ---
NH-40-200PG	11 / ---	11 / ---	--- / ---	--- / ---
NH-40-210PG	11 / ---	*11 / ---	--- / ---	--- / ---

Note: Pump mode with *mark requires trimming impeller diameter according to specific gravity, viscosity and applicable motor.

--- means that operation is not available.

Pump performance curve

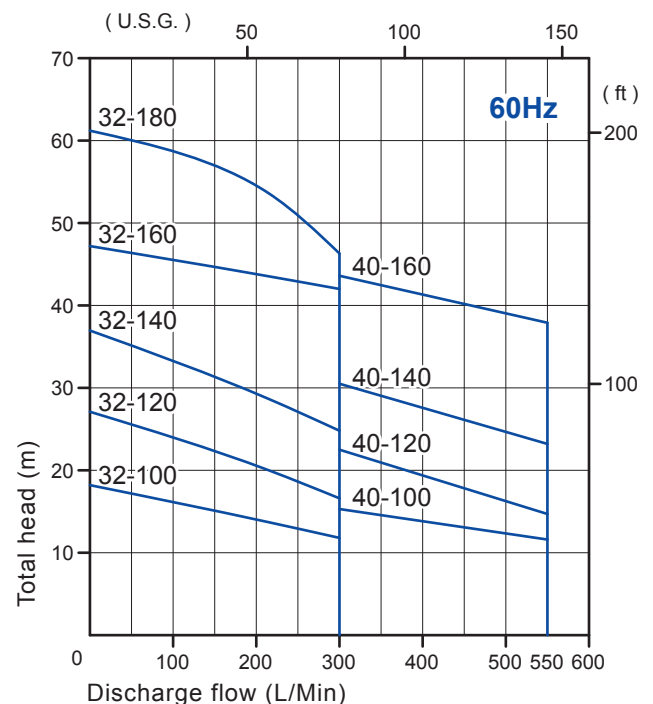
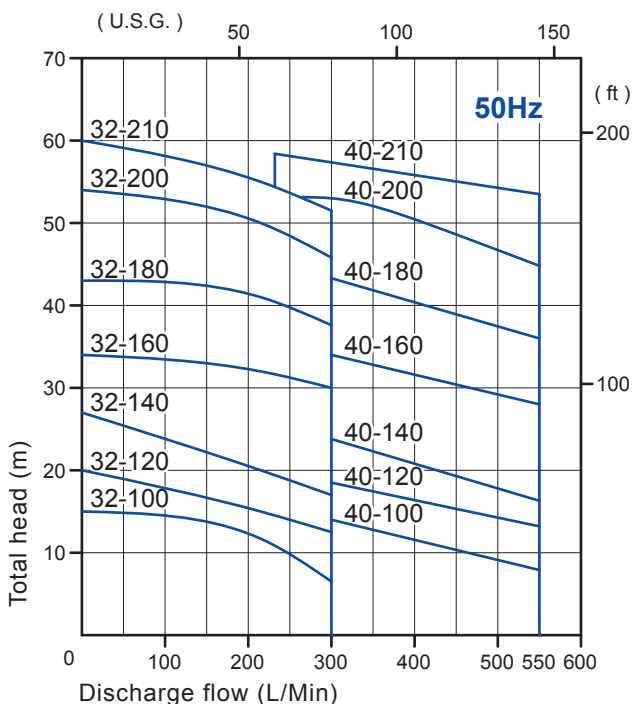

PH Series (Glass Fiber reinforced PPS)

1.5-11kW, Max spec.point: T.D.H. 70m at 540 L/min

Single Stage And Multi Stage Compact Magnetic Driven Pump

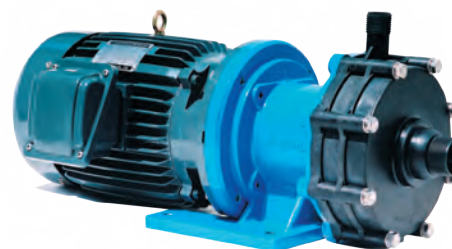

- Pumps available up to 2 stages.
- Precision injection parts.
- Flow rate up to 540 L/min and discharge head to 70m.
- Suitable for P.C.B. machine, Filtration, Etching Machine.
- Applicable IEC motor IEC 1.5kW to 11kw (Also NEMA-C face motor is available).
- Can handle most chemicals up to 90°C.
- Available in BS thread, NPT thread and flange.

Type indication

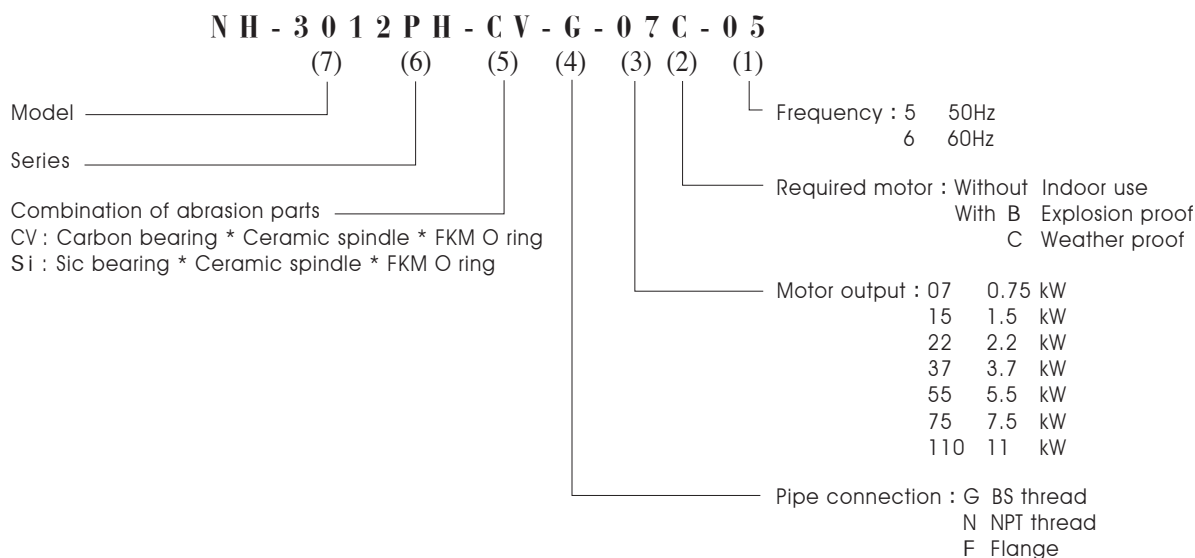

Specification table

Model	Pipe connection	Pump performance		motor kW at L/min discharge flow	Applicable motor, kW		
	Outlet x inlet (mm)	Specified point m at L/min	Max. point M-L/min		S.G. 1.0	S.G. 1.3	S.G. 1.5
NH-3012PH	25 × 40	20 at 100	26 - 180	at 100 L/min	1.5	1.5	2.2
NH-3013PH		30 at 100	36 - 180		2.2	2.2	3.7
NH-3024PH		40 at 100	51 - 180		3.7	3.7	5.5
NH-3026PH		60 at 100	70 - 180		3.7	5.5	5.5
NH-4012PH	40 × 50	20 at 220	25 - 360	at 220 L/min	2.2	3.7	5.5
NH-4013PH		30 at 220	34 - 360		3.7	5.5	7.5
NH-4024PH		40 at 220	49 - 360		5.5	7.5	11
NH-4026PH		60 at 220	68 - 360		7.5	11	11
NH-5012PH	50 × 65	20 at 450	24 - 540	at 450 L/min	3.7	5.5	7.5
NH-5013PH		30 at 450	33 - 540		5.5	7.5	11
NH-5024PH		40 at 450	48 - 540		7.5	11	11

PH Series

Pump performance curve

Nominal speed : 2,860 / 3,440 r.p.m.

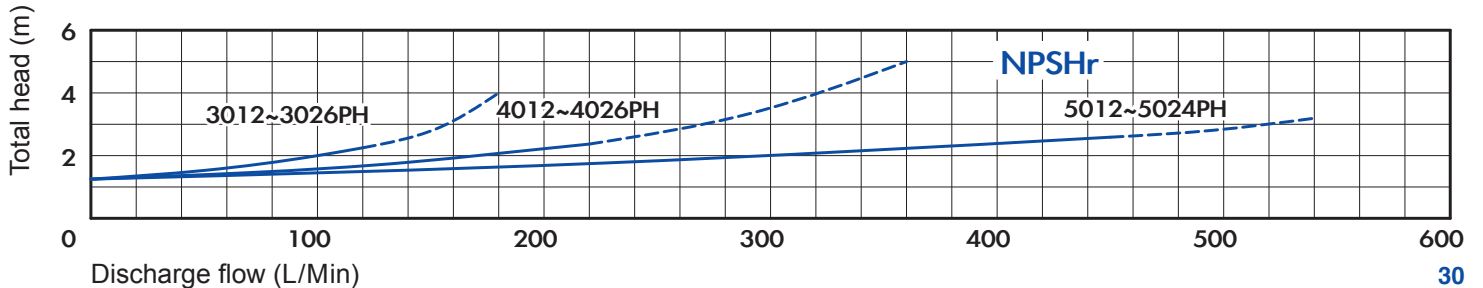
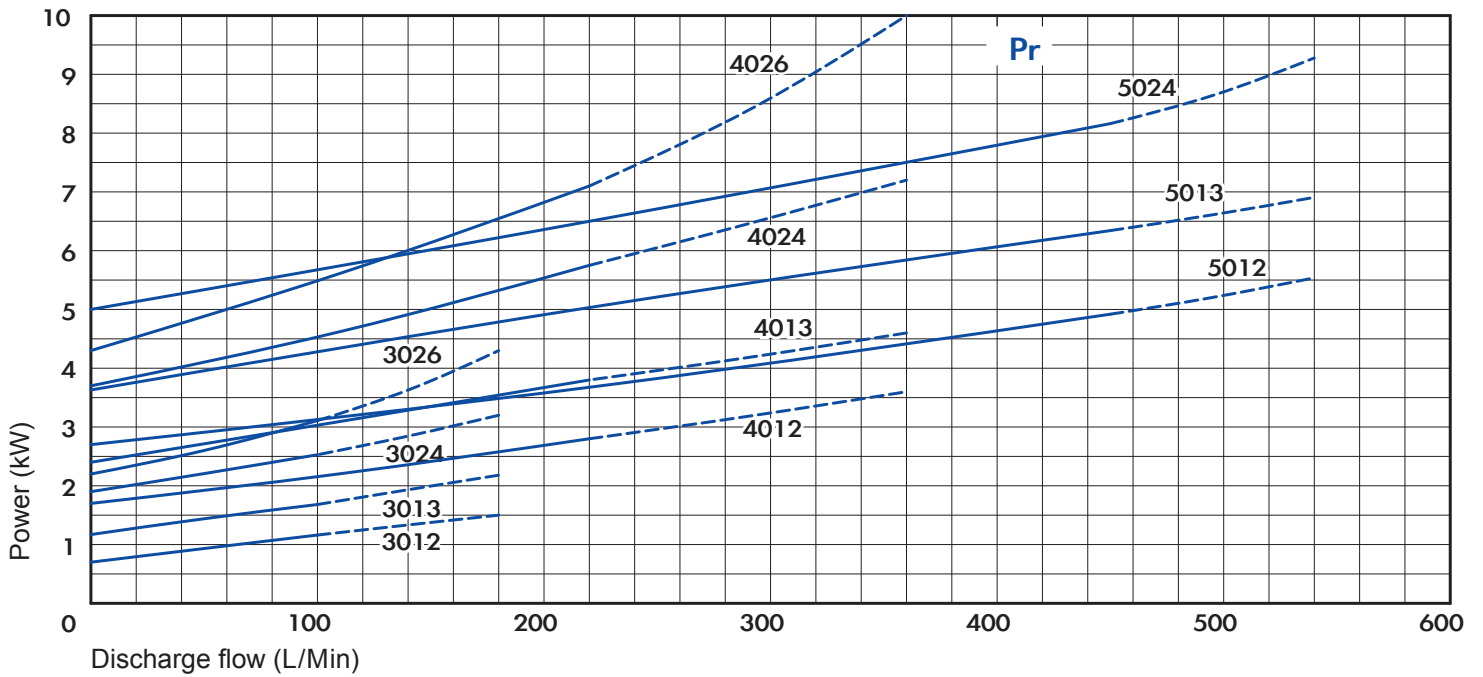
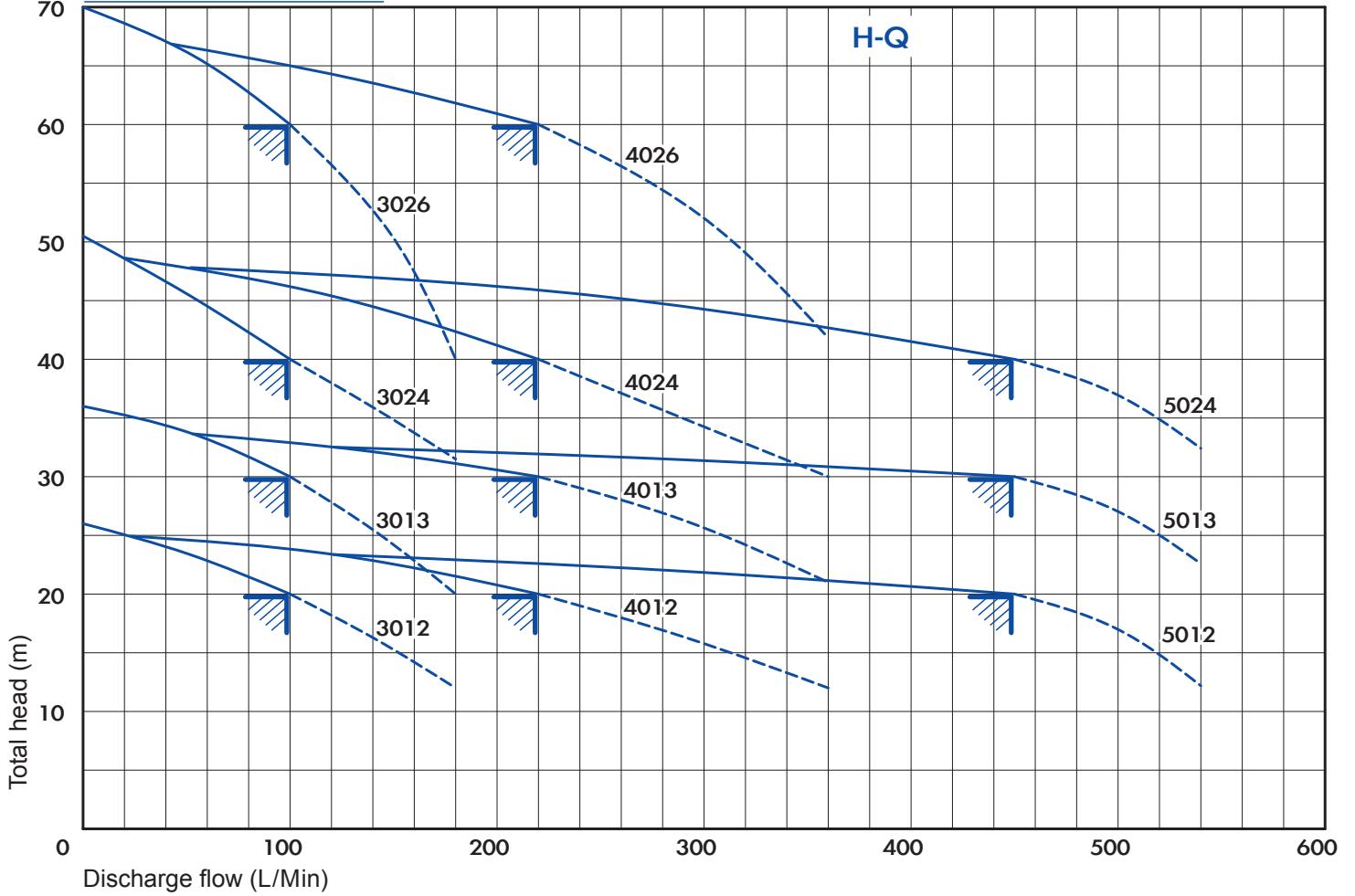

PV Series

Vertical Sump Pump-For On-Tank Installation



- Vertical Sump Pump in FRPP material.
- Precision injection part.
- Available in 11 models with capacity of up to 1050 lit/min and discharge head of 38m.
- Applicable motors are from 0.37kW to 7.5 kW.
- Pump Connections-JIS, CNS, ISO, & ANSI.
- Applications : Printed Circuit Board Machine, Plating Machine, Etching Machine & Filtration Unit.

Type indication

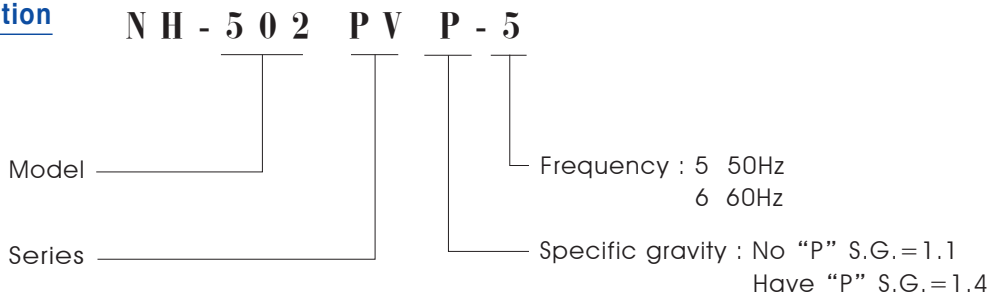

Specification table

Model	Flange Size	Performance, M-L/min, 50~60Hz			Applicable motor output (kW)
	Out x Inlet (mm)	Specific Gravity	Max total head-max discharge	Specified head-specified discharge	
NH-250PV	25 × 25	1.1	8-160 / 4.5-100	6-100 / 3.1-70	0.37
NH-401PV	40 × 50	1.1	11-200 / 11-210	8-140 / 8.5-130	0.75
NH-502PV	50 × 65	1.1	18-320 / 19-400	12-230 / 12-280	1.5
NH-503PV	50 × 65	1.1	23-600 / 27-600	14-450 / 16-420	2.2
NH-505PV	50 × 65	1.1	28-700 / 33-700	21-450 / 23-470	3.7
NH-657PV	65 × 80	1.1	34-750 / 36-850	25-460 / 26-550	5.5
NH-6510PV	65 × 80	1.1	----- / 40-1050	----- / 28.5-700	7.5
NH-503PVP	50 × 65	1.4	21-500 / 22-500	16-300 / 16-250	2.2
NH-505PVP	50 × 65	1.4	27-650 / 30-700	20-350 / 18-540	3.7
NH-657PVP	65 × 80	1.4	29-750 / 35-800	21-470 / 21-530	5.5
NH-6510PVP	65 × 80	1.4	----- / 38-950	----- / 27-600	7.5

Installation dimension (for PV/PVP Series)

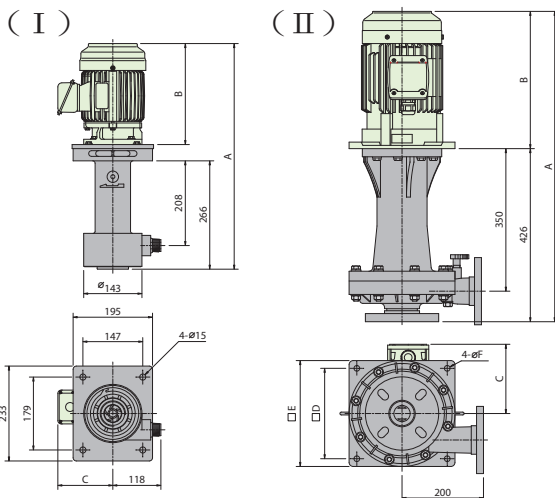

Model	A	B	C	D	E	F	Figure
NH-250PV	554	248	135	—	—	—	(I)
NH-401PV	540	244	145	—	—	—	
NH-502PV	763	337	170	222	260	15	(II)
NH-503PV	763	337	170	222	260	15	
NH-505PV	800	375	185	222	260	15	
NH-657PV	855	430	245	300	352	18	
NH-6510PV	855	430	245	300	352	18	

Pump performance curve

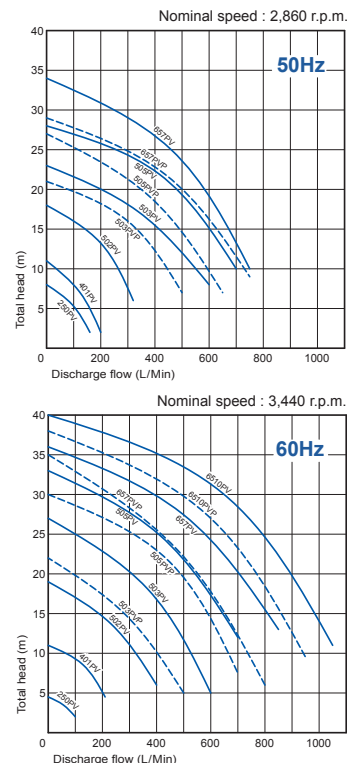

PW-V Series

Magnetic Drive Vertical Sump Pump-For On-Tank Installation

- The world first Magnetic-Drive Vertical Sump Pump in PPG material.
- Precision injection part.
- Available in 7 models capacity of up to 900 lit/min and discharge head of 42m.
- Applicable motors are from 1.5kW to 11kW.
- Pump Connections-JIS, CNS, ISO & ANSI.
- Applications : Printed Circuit Board Machine, Plating Machine, Etching Machine & Filtration Unit.



Pump performance curve

Nominal speed : 2,860 r.p.m.

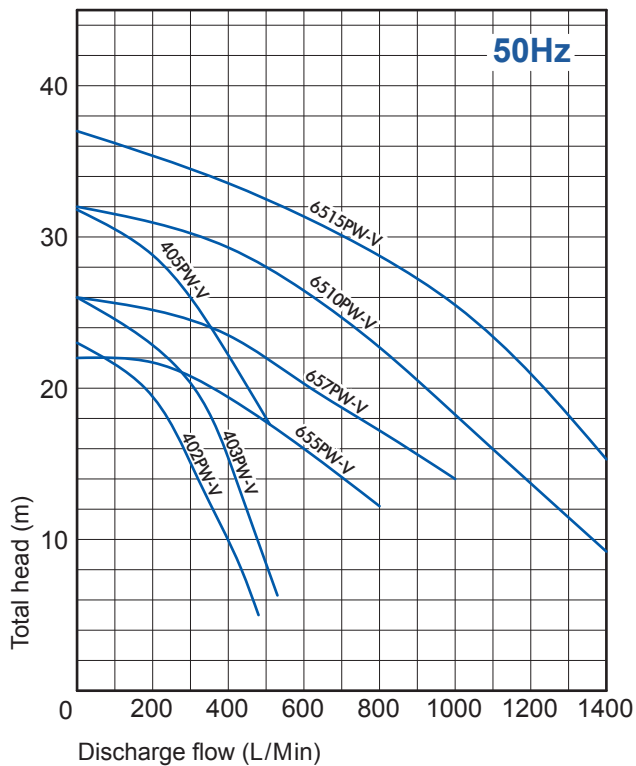

Nominal speed : 3,440 r.p.m.

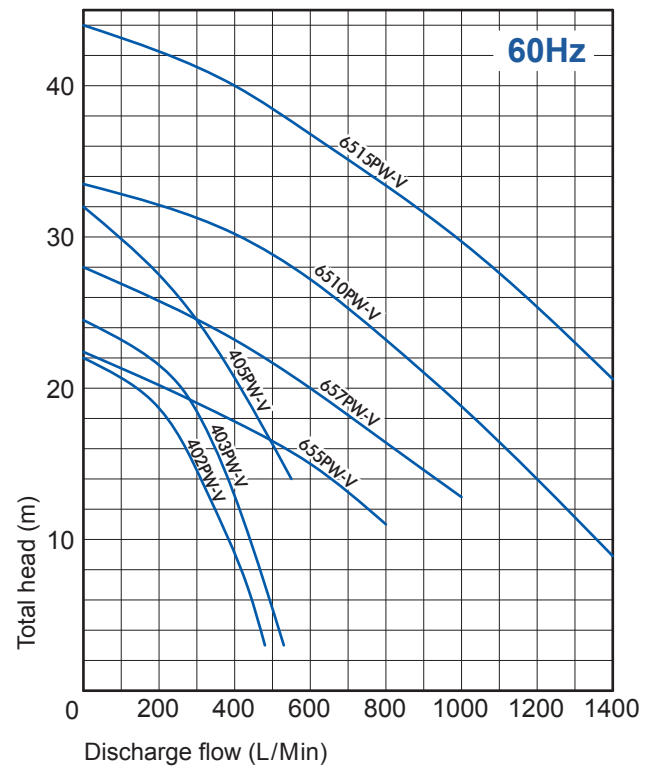

Specification table

Model	Connection		Performance, M-L/min, 50/60Hz		Applicable motor (kW)
	Nominal Flange Size Out x in (A)	Thread connection (inch")	Max total head-max discharge (M-L/Min)	Specified head-specified discharge (M at L/Min)	
NH-402PW-V	50 × 65	2 × 2½	23-480 / 22-480	14 at 320 / 12 at 340	1.5
NH-403PW-V	50 × 65	2 × 2½	26-530 / 24-530	20 at 300 / 19 at 280	2.2
NH-405PW-V	50 × 65	2 × 2½	31-510 / 32-550	14 at 380 / 21 at 340	3.7
NH-655PW-V	65 × 80	2½ × 3	22-800 / 22-800	14 at 700 / 16 at 550	3.7
NH-657PW-V	65 × 80	2½ × 3	26-1000 / 28-1000	17 at 800 / 16 at 800	5.5
NH-6510PW-V	65 × 80	2½ × 3	32-1400 / 33-1400	22 at 800 / 25 at 900	7.5
NH-6515PW-V	65 × 80	2½ × 3	37-1400 / 44-1400	26 at 1000 / 29 at 1000	11

PM-V Series (PPS)
PM-V-F Series (ETFE)
Multistage Magnetic Drive Pumps (Vertical Inline)



- The world first multistage magnetic drive pump in PPS & ETFE material.
- Precision injection part, glass fiber-reinforced PPS and ETFE.
- Pumps available from 3 to 11 stages.
- Flow rates up to 100 lit/min and discharge head to 90m.
- Applicable motors, IEC 0.37kW to 2.2kW.

PM-E Series (PPS)
PM-E-F Series (ETFE)
Multistage Magnetic Drive Pumps (Semi-Submersible End-suction)



- The world first multistage magnetic drive pump in PPS & ETFE material.
- Precision injection part, glass fiber-reinforced PPS and ETFE.
- Pumps available from 3 to 11 stages.
- Flow rates up to 100 lit/min and discharge head to 90m.
- Applicable motors, IEC 0.37kW to 2.2kW.

Expected performance curve

Specification table

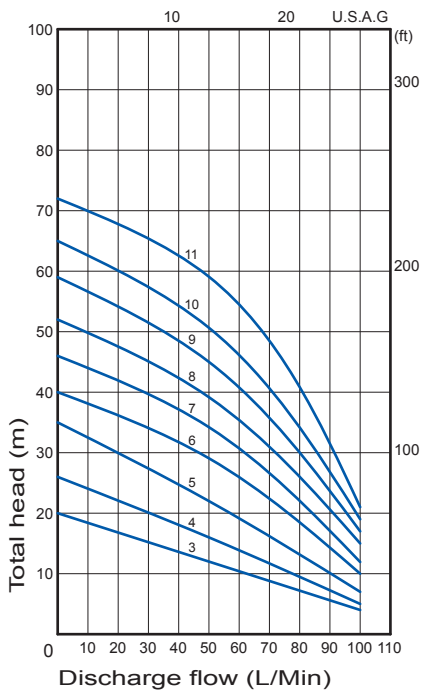

Model	Connection Out x in (mm)	Max total head-max discharge (M-L/Min)	Applicable IEC motor (kW)	Net Weight (Kg)
NH-250PM-3	NPT 1"(Thread) 25 x 25 mm(Union) 25 x 25 A(Flange)	20 - 100	0.37	9.5
NH-250PM-4		27 - 100	0.37	10.5
NH-250PM-5		35.5 - 100	0.75	13
NH-250PM-6		44.5 - 100	1.5	13.5
NH-250PM-7		53 - 100	1.5	14
NH-250PM-8		62 - 100	1.5	14.5
NH-250PM-9		71.5 - 100	1.5	15
NH-250PM-10		80 - 100	2.2	15.5
NH-250PM-11		88 - 100	2.2	16.5

Note: Power requirement/motor is determined by S.G, viscosity and number of impellers.

PF-S & PF-L Series Mechanical Drive Dosing Pump

- Wetted-end material available in PP, SUS, Teflon or Hastelloy C.
- 15 Models with max flow rates of up to 25 lit/min (50Hz) and discharge pressure to 15 bars.
- Applicable for most chemical dosing.
- Also available in Duplex type.



Combination of construction material

Combination	PC	PS	SS	TC
Pump head	Polypropylene	Polypropylene	SUS 316	PTFE
Ball valve	Ceramic	SUS 316	SUS 316	Ceramic
Valve seat	PVC	SUS 316	SUS 316	PTFE
Oring	FKM	EPDM	EPDM	FKM
Diaphragm	PTFE	PTFE	PTFE	PTFE

Accessories

1).Relief valve and Back pressure valve

Connection	Relief valve		Back pressure valve	
	PVC	SUS 316	PVC	SUS 316
15A Flange	NH-SV-1FP	NH-SV-1FS	NH-NV-1PF	NH-NV-1FS
Ø5x Ø9 Hose	NH-SV-1HP	NH-SV-1HS	NH-NV-1HF	NH-NV-1HS
20A Flange	NH-SV-2FP	NH-SV-2FS	NH-NV-2PF	NH-NV-2FS
Ø13x Ø18 Hose	NH-SV-2HP	NH-SV-2HS	NH-NV-2HF	NH-NV-2HS
25A Flange	NH-SV-3FP	NH-SV-3FS	NH-NV-3PF	NH-NV-3FS
40A Flange	NH-SV-4FP	NH-SV-4FS	NH-NV-4PF	NH-NV-4FS
50A Flange	NH-SV-5FP	NH-SV-5FS	NH-NV-5PF	NH-NV-5FS

2).Air chamber

Connection	model name/Allowable pressure, Bar		Effective capacity
	PVC	SUS 316	
15A Flange	NH-AC-1P / 10	NH-AC-1S / 15	3L
20A Flange	NH-AC-2P / 10	NH-AC-2S / 10	5L
25A Flange	NH-AC-2P / 5	NH-AC-2S / 5	5L
40A Flange	NH-AC-3P / 5	NH-AC-3S / 5	10L
50A Flange	NH-AC-4P / 5	NH-AC-4S / 5	20L

Performance table(Reference)

Model	Max. Discharge capacity (L/Min)		Max. Discharge Pressure, Bar			Accuracy (%)	Stroke speed (S.P.M)		Connection		Original motor output, kW	Apporx, kg net weight	
	50Hz	60Hz	PP	PTFE	SUS		50Hz	60Hz	Hose	Flange		PP	SUS
PF-S-6S	0.062	0.075	10	10	15	±1.75	48	58	Ø5 x Ø9	16K, 15A	0.2	14	17
PF-S-12H	0.110	0.130	10	10	15	±1.75	96	116	Ø5 x Ø9	16K, 15A	0.2	14	17
PF-S-30S	0.300	0.360	10	10	15	±1.75	48	58	Ø5 x Ø9	16K, 15A	0.2	15	20
PF-S-60H	0.580	0.700	10	10	15	±1.75	96	116	Ø5 x Ø9	16K, 15A	0.2	15	08
PF-S-120S	1.00	2.00	10	10	10	±1.25	48	58	Ø13 x Ø18	10K, 20A	0.2	17	24
PF-S-200H	2.00	2.40	8	8	8	±1.25	96	116	Ø13 x Ø18	10K, 20A	0.2	17	24
PF-S-300S	2.92	3.00	5	5	5	±1.25	48	58	Ø13 x Ø18	10K, 20A	0.2	19	27
PF-S-400S	3.30	4.00	4	4	4	±1.25	48	58	-----	10K, 25A	0.2	19	27
PF-S-600H	5.83	7.00	3	3	3	±1.25	96	116	-----	10K, 25A	0.2	21	30
PF-S-800H	6.67	8.80	2	2	2	±1.25	96	116	-----	10K, 25A	0.2	22	30
PF-L-600H	5.83	7.00	5	5	5	±1.25	96	116	-----	10K, 40A	0.37	38	47
PF-L-800H	6.67	8.80	5	5	5	±1.25	96	116	-----	10K, 40A	0.37	40	48
PF-L-1000S	10.00	12.00	5	5	5	±1.25	48	58	-----	10K, 50A	0.75	77	87
PF-L-2000S	18.00	22.00	5	5	5	±1.25	96	116	-----	10K, 50A	0.75	81	92
PF-L-3000S	25.00	30.00	5	5	5	±1.25	96	116	-----	10K, 50A	1.5	95	118

Note:

1. Flow rates and accuracy shown are at 100% stroke length.
2. Recommended duty is between 25-100% stroke length.
3. Pumps fitted with original motor, either 3-ph or 1-ph.
4. Explosion-proof motors available on request.
5. Performance is based on clean water at 40 °C .
6. Duplex type is available for models, PF-6S to PF-800H fitted with 0.2kW motor.

PA Series Industrial Mixers

- Available in rubber-lined SUS wetted-end material.
- With universal clamp connection and twin-propeller as standard.
- Suitable for high viscous liquid.
- Mixers available in length from 800 to 1800mm.
- Fitted with original motor, 0.1 to 2.2kW and rotation speed 297rpm.



Specification

Model	Applicable motor	Propeller dia-rod dia x rod length (mm)	Wetted end	Net Weight (Kg)
NH-10PA	0.1kW, 3 phase	160mm-16 × 800	SUS304	17.5
NH-20PA	0.2kW, 3 phase	200mm-16 × 1,000	SUS304	18
NH-40PA	0.4kW, 3 phase	250mm-22 × 1,200	SUS304	32
NH-75PA	0.75kW, 3 phase	300mm-22 × 1,350	SUS304	52
NH-20PA-V	0.2kW, 3 phase	200mm-16 × 1,000	SUS304	32
NH-40PA-V	0.4kW, 3 phase	250mm-22 × 1,200	SUS304	41
NH-75PA-V	0.75kW, 3 phase	300mm-22 × 1,400	SUS304	49
NH-150PA-V	1.5kW, 3 phase	350mm-32 × 1,600	SUS304	85
NH-220PA-V	2.2kW, 3 phase	400mm-32 × 1,800	SUS304	94
NH-40PA-V-S	0.4kW, 3 phase	250mm-16 × 1,200	Rubber lined	41
NH-75PA-V-S	0.75kW, 3 phase	300mm-22 × 1,400	Rubber lined	49
NH-150PA-V-S	1.5kW, 3 phase	350mm-32 × 1,600	Rubber lined	85
NH-220PA-V-S	2.2kW, 3 phase	400mm-32 × 1,800	Rubber lined	94

PA-S Series Chemical Stirrers

- Available in PVDF or SUS316 wetted-end material.
- Flange connection for tank top mounting.
- Standard length of 490mm, 690mm and 890mm.
- Driven by 20w/1400rpm TELC motor.



Model identification

NH - PA - S - 3 - P - 4

Series name _____

Model _____

Length 4 : 490mm

6 : 690mm

8 : 890mm

Wetted end P : ECTFE coated

S : SUS-316

PD Series

Pan World Dry Running Protector

- Compact design.
- Two integral current transformers.
- Wide range current adjustment.
- Definite trip time characteristic.
- Manual (instantaneous)/Electric (remote) reset.
- Easy maintenance.



Specification table

	PD-05	PD-30	PD-60
Current range	0.5 - 5A	3.0 - 30A	5.0 - 60A
Trip time setting	0.2 - 30 sec.		
Power supply	3 phase 220V AC		
Output relay	3A 250V AC		

N H - P D - 0 5 - 2 2 0

(3) (2) (1)

Series

Supply voltage

Operation current : 05 : 0.5-5A
 30 : 3.0-30A
 60 : 5.0-60A

PT Series

Dimension

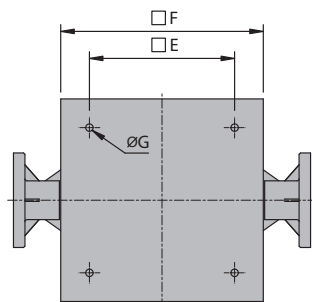
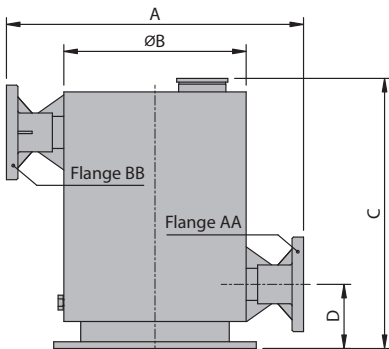

	A	B	C	D	E	F	G	AA	BB
PT-400	440	270	400	95	215	300	Ø11	40A	40A
PT-401	440	270	470	115	215	300	Ø11	40A	40A
PT-402	440	270	550	115	215	300	Ø11	50A	50A

NOTE:

- 1) Material hard PVC.
- 2) Allowable self priming static head 3m at S.G./1.0.
- 3) Allowable over all suction pipe length 4m.

Areas of Application

Series	PX/PX-D/PS	PX-N/PX-N-D/PX-F PX-F-D/PS-F/PS-K	PW/PW-SP PS-N/PW-N PS-N-K/PW-N-K	PW-F/PW-K	PW-C/PW-XJ	PM-V PM-E	PF-S PF-L	PW-V/PV	PA/PA-S	PG
Classification	Magnetic pump	Magnetic pump	Magnetic pump	Magnetic pump	Magnetic pump	Magnetic pump	Dosing pump	Sump pump	Mixer	Magnetic pump
Filtration	*		*			*				
P.C.B.machine			*			*		*		
Etching machine	*	*	*	*		*		*		
Chemical, Electric plating	*	*	*	*		*		*	*	
Scrubber			*							
Waste water treatment			*	*	*	*	*			
Chemical transfer	*	*	*	*	*	*			*	*
Chemical refine process			*	*	*	*				
Pharmaceutical	*	*	*	*		*	*		*	*
Shadow mask machine			*	*	*	*	*		*	
C.R.T.producing			*	*	*	*				
Metal degreasing				*	*					
Glass etching				*	*					
Paper industry			*	*	*	*	*			*
Laboratory application	*	*	*						*	
Vending machine	*									
Food process			*	*	*	*	*			*
Deionizing equipment	*	*	*	*	*	*	*		*	*
Semi-conductor		*		*		*				
Ice machine	*									
Juice server	*									
Power station					*		*			
Salt industry			*						*	*
Battery industry	*	*	*	*	*	*	*			
Waste chemical transfer	*	*	*	*	*	*			*	
Chemical controller	*									
MC/CNC machinery	*									



PAN WORLD GROUP OF COMPANIES

Pan World Co., Ltd. (Japan)

TPW, Hong Yuan Co., Ltd. (Taiwan)

ISO9001 Certified

Pan World Asia Pacific Pte., Ltd. (Singapore)

ISO 9001 Certified

Jen Fu Technology Inc. (Taiwan)

Shenzhen Rongchao Industry Co., Ltd.

(Guangzhou, China)

Shinfu Mechanical Co., Ltd. (China)

Pan World Rep. Office (U.S.A)

MPP (Phils) Inc. (Philippines)



PAN WORLD CO LTD

1097-18 MITSUKAIDO YAMADA-CHO,
JYOUSOU-SHI, IBARAKI-KEN, JAPAN

TEL : (81) 297-23-5560

FAX : (81) 297-23-5561

E-mail : aricomx@mx5.nisiq.net

http: www.panworld-jp.com

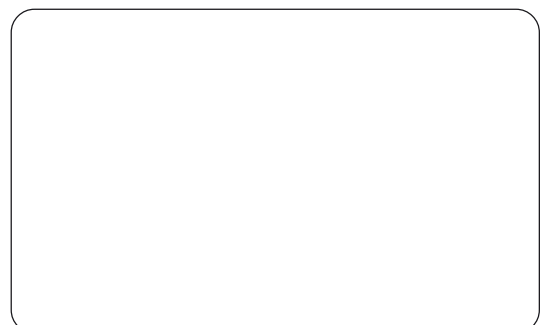

Specifications are subjected to changes without prior notice.